

**AGENDA**  
**MACON COUNTY BOARD MEETING**  
**THURSDAY, JANUARY 9, 2014 - 6:00 P.M.**  
**141 SOUTH MAIN, ROOM 514**

1. **CALL TO ORDER**
2. **ROLL CALL**
3. **OPENING PRAYER**
4. **PLEDGE OF ALLEGIANCE**
5. **APPROVAL OF MINUTES OF PRIOR MEETING**
6. **ZONING/SUBDIVISIONS**
  - Z-1130-1-14 **Macon County Board Resolution  
Regarding Case S-01-12-13, A Petition for  
Special Use Permit Submitted by City of  
Decatur**
  - Z-1131-1-14 **Macon County Board Resolution  
Regarding Case S-02-12-13, A Petition for  
Special Use Permit Submitted by Enbridge  
Energy, Limited Partnership**
7. **CORRESPONDENCE**
8. **CLAIMS**
9. **APPOINTMENTS**
  - G-4021-1-14 **Macon County Board Resolution  
Appointment to the Decatur – Macon  
County Opportunities Corporation  
(DMCOC) – Antonio D. Brown**
  - G-4022-1-14 **Macon County Board Resolution  
Appointment to the Macon County  
Regional Planning Commission – Patrick  
Murphy**
10. **CONSENT CALENDAR**
  - G-4023 -1-14 **Macon County Board Resolution**

**to Execute Deeds to Convey Property  
on which Taxes were Delinquent**

**11. JUSTICE COMMITTEE  
G-4024-1-14**

**Macon County Board Resolution  
Approving Increase in Appropriations in  
the Probation Grant Fund for Juvenile  
Redeploy Illinois Grant**

**G-4025-1-14**

**Macon County Board Resolution  
Approving Increase in Appropriations in  
the Circuit Court's FY14 Budget for  
Expenses Fees in Certain Appeals**

**12. EEHW COMMITTEE**

**13. OPERATIONS AND PERSONNEL COMMITTEE  
G-4026-1-14**

**Macon County Board Resolution  
Accepting a One Year Proposal from A J  
Gallagher for Property and Inland Marine  
Insurance Coverage**

**G-4027-1-14**

**Macon County Board Resolution Setting  
the Salary for Office of County Clerk  
Elected 2014 – 2018**

**G-4028-1-14**

**Macon County Board Resolution  
Approving a Budget Amendment for  
Workforce Investment Solutions FY13 &  
FY14 Budgets – Trade Adjustment  
Assistance Grant**

**G-4029-1-14**

**Macon County Board Resolution  
Approving a Budget Amendment for  
Workforce Investment Solutions FY14  
Budget – Rapid Response Grant**

**G-4030-1-14**

**Macon County Board Resolution  
Approving a Budget Amendment for  
Workforce Investment Solutions FY14  
Budget – Summer Youth Employment  
Program**

**14. LEGISLATIVE COMMITTEE**

15. **FINANCE COMMITTEE**  
**G-4031-1-14**  
**Macon County Board Resolution**  
**Approving Application of the Decatur**  
**public Building Rent Surplus and for**  
**Reduction in the Levy for the DPBC Fund**
  
- G-4032-1-14**  
**Macon County Board Resolution**  
**Approving Increase in Appropriations in**  
**the General Fund**
  
- G-4033-1-14**  
**Macon County Board Resolution**  
**Approving Increase in Appropriations in**  
**the FY13 Budget**
  
16. **NEGOTIATIONS COMMITTEE**
17. **TRANSPORTATION COMMITTEE**
18. **EXECUTIVE COMMITTEE**
19. **SITING, RULES & ORDINANCE SUB-COMMITTEE**
20. **BUILDING SUB-COMMITTEE**
21. **CITIZENS' REMARKS**  
(Public Comment Limited to Total of 20 Minutes, 5 Minutes Maximum Per Person)
22. **OFFICEHOLDERS' REMARKS**
23. **OLD BUSINESS**
24. **NEW BUSINESS**
25. **CLOSED SESSION -Personnel Issues/ Pending Litigation / Collective Bargaining Negotiations**
26. **ADJOURNMENT**

**MACON COUNTY BOARD RESOLUTION  
REGARDING CASE S-01-12-13, A PETITION FOR SPECIAL USE  
PERMIT SUBMITTED BY CITY OF DECATUR**

**RESOLUTION NO. Z-1130-1-14**

**WHEREAS**, a petition was filed by City of Decatur requesting a renewal of a Special Use Permit for the operation and management of a Silt Retention Basin in A-1 Agricultural zoning. The property is legally described as:

Parts of Sections 2 and 3 of T16N, R3E of the 3rd PM as follows: That part of the NE ¼ of said Sec. 2 lying Nrlly of R-O-W Norfolk & Southern R.R., EXCEPT N 350' of W 844' thereof, and EXCEPT N 355' of NE ¼ of NE ¼ of said Sec. 2, and NW ¼ of said Sec. 2, EXCEPT N 347.5' of E 412.5' thereof, and NE ¼ of said Sec. 3, EXCEPT S 225.13' of W 450.27' thereof; and NE ¼ of NW ¼ of said Sec 3, EXCEPT N 24.53 acres thereof, and EXCEPT S 286' of W 456.92' thereof; and Beg. At NE corner of SE ¼ of NW ¼ of said Sec 3, th S 191.04', th W 1377.11 to W line of SE ¼ of NW ¼ of said Sec 3, the N 194.62' to NW corner of SE ¼ of NW ¼ of said Sec 3, th E to P.O.B.

The property is bounded by Angle Crossing Road on the North, Prairie View Road on the East, and Kitchen Road on the South. This tract is generally ¼ miles East of Sangamon Rd (County Highway 23) but is adjacent to Sangamon Road at two points about ¼ mile South of Angle Crossing Road in Oakley Township and contains 528.65 acres.

**WHEREAS**, staff recommended at hearing the petition be granted with the following stipulations:

1. A site Maintenance Advisory Committee ("Committee") shall be created to assist the City of Decatur in fulfilling the following terms and conditions of this Special Use Permit. The Committee shall monitor the maintenance operations at the facility and provide advice regarding the implementation of this Special Use Permit and the Site Reclamation Plan. This committee shall also serve as the clearinghouse for citizen complaints, concerns, and suggestions regarding the operations and maintenance of the site.

a. Committee membership shall consist of:

- One member representing Macon County appointed by the Macon County Board
- One member representing Oakley Township appointed by Oakley Township Board of Trustees
- One member representing the Macon County Soil and Water Conservation District appointed by the Macon County Soil and Water Conservation District Board.
- Two members representing the City of Decatur appointed by the Decatur City Council

b. The Committee shall meet at least on a bi-monthly basis with additional meetings to be called as needed to address immediate concerns. All meetings of the Committee shall be subject to the regulations and standards of the Open Meetings Act. All meetings of the Committee shall reserve time for the public to present verbal and/or written comments regarding site maintenance and/or reclamation issues. The Committee shall be empowered to adopt by-laws; and



2. The City of Decatur ("City") will establish and maintain a dedicated funds account to provide the Committee with the necessary financial resources in the event it has to hire a contractor to complete an aspect of site maintenance. The City shall maintain a minimum balance of \$60,000 in this dedicated funds account. The Committee shall be empowered to utilize this account under the following process:

- a. When a concern or complaint regarding site maintenance is brought to the Committee's attention, it shall be forwarded to the City's Water Management Department within 10 business days.
- b. The City shall have 30 business days to resolve the matter to the satisfaction of the Committee.
- c. If the matter is not resolved within the allotted time, the Committee may call a special meeting to discuss and vote on a plan of action.
- d. Once the Committee has approved a plan of action, the Committee should arrange for a private contractor to perform the necessary site maintenance. The work shall be performed by a pre-approved contractor. The City shall provide the Committee with a list of pre-approved contractors from which to choose.
- e. All such contract work shall be paid from the dedicated funds account, with a copy of all correspondence, invoices, and receipts forwarded to the City; and

3. The City shall ensure facility maintenance and that vegetative growth will comply with all Macon County Nuisance Ordinance Regulations. There shall be no vegetative overgrowth visible from the surrounding perimeter roads; and

4. The City shall remit payment annually on August 1st to the various taxing districts for the loss of property tax revenue. The compensation shall be calculated each year by multiplying the certified assessed value for PI 121 by 529 acres and then multiplying by the individual tax rate for each taxing district. Each year the certified assessed values for farmland shall come from the Illinois Department of Revenue and the individual tax rates shall come from the Macon County Clerk. By January 15, 2014, The City of Decatur, shall pay all various districts the difference between the property taxes that were paid from 2006 to 2012 and what would have been due for the entire 529 acre parcel if used for crop production as (per the existing Special Use Permit) that was calculated by the Macon County Supervisor or Assessments using the calculation stated above in Stipulation 4. (See Attachment); and

5. Should the City decide to sell the 529 acre property in question, or any portion thereof, right of first refusal to purchase the property at fair market value shall be offered to the individuals, or their immediate heirs, from whom the City purchased property; and

6. Prior to approval of the Special Use Permit, the City of Decatur shall have a signed road use agreement with the Oakley Township Road Commissioner; and

7. All water drainage from inside the berm during construction and dredging operations shall drain to the west and shall comply with Illinois Drainage Laws and Illinois Department of Natural Resources dam (berm) requirements. A land disturbance permit is required for the acres disturbed in raising the berm; and

8. The Special Use shall be required to remain in conformance with all applicable local, state, and federal laws and regulations. Any violations of these applicable laws and regulations may result in penalties and fines as identified in Section 4.12 of the Macon County Zoning Ordinance. These penalties and fines would

be in addition to any penalties and fines mandated by the other local, state, or federal regulatory agency; and

9. The conditions of this Special Use Permit may be modified through the adoption, by County Board resolution, of an amendment to this permit. Any amendment shall be reviewed and approved in the same manner as this original permit or by the identified process for obtaining a Special Use Permit as indicated in the Macon County Zoning Ordinance; and

10. The Special Use Permit will have a 10 year limit for all to review at the end of that time limit. The Special Use Permit will expire on January 9, 2024.

**WHEREAS**, at the required public hearing on December 4, 2013, your Zoning Board of Appeals heard the testimony presented and voted 5-0 in favor of recommending to the County Board the petition be granted subject to the stipulations as set forth above.

**WHEREAS**, on December 19, 2013, your EEHW Committee heard the summary report and hereby recommends by the following 4-0 vote that the County Board approve the subject petition for a Special Use Permit to allow the operation and management of a Silt Retention Basin in A-1 Agricultural zoning subject to the above stipulations recommended by the Zoning Board of Appeals.

**NOW, THEREFORE, BE IT RESOLVED** by the Macon County Board to \_\_\_\_\_ the subject petition for a Special Use Permit to allow the operation and management of a Silt Retention Basin in A-1 Agricultural zoning subject to the above stipulations recommended by the Zoning Board of Appeals.

**BE IT FURTHER RESOLVED** that this resolution shall become effective immediately upon the adoption thereof.

**PRESENTED, PASSED, APPROVED this 9<sup>th</sup> day of January, 2014.**

Ayes \_\_\_\_\_ NAYS \_\_\_\_\_

MACON COUNTY BOARD  
MACON COUNTY, ILLINOIS

ATTEST:

BY:

\_\_\_\_\_  
Stephen M. Bean, Clerk for the  
County of Macon, State of Illinois

\_\_\_\_\_  
Jay A. Dunn, Chairman  
Macon County Board

Property	Certified Values for Productivity Index 121 (2006 to 2014)									
	2006	2007	2008	2009	2010	2011	2012	2013	2014	2014
Acreage	529	180.22	183.20	201.52	221.67	243.84	268.22	295.04	324.54	357.00
All Parcels										
Calculated Assessed Values Based on Productivity Index 121 Certified Values (2006 to 2014)										
Property	2006	2007	2008	2009	2010	2011	2012	2013	2014	2014
All Parcels	529	\$ 95,336.38	\$ 96,912.80	\$ 106,604.08	\$ 117,263.43	\$ 128,991.36	\$ 141,888.38	\$ 156,076.16	\$ 171,681.66	\$ 188,853.00
Total Assessed:	529	\$ 95,336.38	\$ 96,912.80	\$ 106,604.08	\$ 117,263.43	\$ 128,991.36	\$ 141,888.38	\$ 156,076.16	\$ 171,681.66	\$ 188,853.00

Property	Calculated Tax Due Based on Productivity Index 121 Certified Values (2006 to 2012)										Total
	2006	2007	2008	2009	2010	2011	2012	2013	2014		
Acreage	529	\$ 7,446.50	\$ 7,448.21	\$ 7,952.99	\$ 8,760.69	\$ 9,734.24	\$ 10,788.28	\$ 11,947.78	\$ -	\$ -	\$ 64,073.70
Total Calculated Tax:	529	\$ 1,878.20	\$ 1,958.74	\$ 2,091.20	\$ 2,302.92	\$ 2,424.42	\$ 2,375.22	\$ 1,514.90	\$ -	\$ -	\$ 12,363.60
Total Owed:	529	\$ 5,568.30	\$ 5,489.47	\$ 5,861.79	\$ 6,457.77	\$ 7,308.82	\$ 8,413.07	\$ 10,432.88	\$ -	\$ -	\$ 51,710.10

Total Owed to Each Taxing Body (2006-12)	2006	2007	2008	2009	2010	2011	2012	2013	2014	Total by Body
	Cerro Gordo School #100	\$ 3,301.51	\$ 3,242.10	\$ 3,403.09	\$ 3,769.16	\$ 4,905.91	\$ 5,375.38	\$ 5,947.46	\$ -	\$ -
Cerro Gordo Fire	\$ 133.21	\$ 125.87	\$ 133.00	\$ 137.95	\$ 175.51	\$ 191.58	\$ 205.54	\$ -	\$ -	\$ 1,102.66
Co. Health & Mental Health	\$ 165.44	\$ 165.56	\$ 193.12	\$ 211.67	\$ 275.12	\$ 299.27	\$ 344.24	\$ -	\$ -	\$ 1,654.42
Conservation District	\$ 75.29	\$ 73.92	\$ 80.65	\$ 86.60	\$ 114.22	\$ 125.37	\$ 146.00	\$ -	\$ -	\$ 702.04
Cooperative Extension	\$ 18.46	\$ 17.56	\$ 18.81	\$ 20.03	\$ 26.80	\$ 29.42	\$ 33.33	\$ -	\$ -	\$ 164.41
County Tax	\$ 670.33	\$ 676.27	\$ 736.21	\$ 823.65	\$ 1,079.79	\$ 1,183.02	\$ 1,244.89	\$ -	\$ -	\$ 6,414.17
Hope - Welty Public Library	\$ 131.42	\$ 129.74	\$ 141.20	\$ 155.01	\$ 197.63	\$ 220.86	\$ 234.73	\$ -	\$ -	\$ 1,210.59
Oakley Cemetery	\$ 57.03	\$ 56.35	\$ 61.61	\$ 66.43	\$ 89.50	\$ 99.04	\$ 109.02	\$ -	\$ -	\$ 538.99
Oakley Township	\$ 712.39	\$ 693.64	\$ 754.78	\$ 813.88	\$ 1,096.30	\$ 1,234.19	\$ 1,389.73	\$ -	\$ -	\$ 6,694.91
Richland CC 537	\$ 275.74	\$ 281.50	\$ 309.81	\$ 341.15	\$ 486.64	\$ 591.76	\$ 658.03	\$ -	\$ -	\$ 2,944.62
W-O Mul-TP Asmt	\$ 27.48	\$ 26.96	\$ 29.51	\$ 32.25	\$ 44.39	\$ 63.18	\$ 69.68	\$ -	\$ -	\$ 293.46
Miacon Mosq. Abatement										\$ 45.23
Totals by Year:	\$ 5,568.30	\$ 5,489.47	\$ 5,861.79	\$ 6,457.77	\$ 8,491.82	\$ 9,413.07	\$ 10,427.88	\$ -	\$ -	\$ 51,710.10

2006	Tax Districts	Tax Rate		Crosscheck
	Cerro Gordo School #100	4.63109%	\$ 4,415.11	
<b>Total Assessed Value:</b>	Cerro Gordo Fire	0.18686%	\$ 178.15	
<b>\$ 95,336.38</b>	Co. Health & Mental Health	0.23207%	\$ 221.25	
	Conservation District	0.10561%	\$ 100.68	
	Cooperative Extension	0.02589%	\$ 24.68	
	County Tax	0.94028%	\$ 896.43	
	Hope- Welty Public Library	0.18434%	\$ 175.74	
	Oakley Cemetary	0.08000%	\$ 76.27	
	Oakley Township	0.99929%	\$ 952.69	
	Richland CC 537	0.38678%	\$ 368.74	
	W-O Mul-TP Asmt	0.03855%	\$ 36.75	Sum =
		<u>7.81076%</u>	<u>\$ 7,446.50</u>	\$ 7,446.50

2007	Tax Districts	Tax Rate		Crosscheck
	Cerro Gordo School #100	4.53907%	\$ 4,398.94	
<b>Total Assessed Value:</b>	Cerro Gordo Fire	0.17622%	\$ 170.78	
<b>\$ 96,912.80</b>	Co. Health & Mental Health	0.23179%	\$ 224.63	
	Conservation District	0.10349%	\$ 100.30	
	Cooperative Extension	0.02459%	\$ 23.83	
	County Tax	0.94681%	\$ 917.58	
	Hope- Welty Public Library	0.18164%	\$ 176.03	
	Oakley Cemetary	0.07889%	\$ 76.45	
	Oakley Township	0.97112%	\$ 941.14	
	Richland CC 537	0.39411%	\$ 381.94	
	W-O Mul-TP Asmt	0.03775%	\$ 36.58	Sum =
		<u>7.68548%</u>	<u>\$ 7,448.21</u>	\$ 7,448.21

2008	Tax Districts	Tax Rate		Crosscheck
	Cerro Gordo School #100	4.33112%	\$ 4,617.15	
<b>Total Assessed Value:</b>	Cerro Gordo Fire	0.16927%	\$ 180.45	
<b>\$ 106,604.08</b>	Co. Health & Mental Health	0.24579%	\$ 262.02	
	Conservation District	0.10264%	\$ 109.42	
	Cooperative Extension	0.02394%	\$ 25.52	
	County Tax	0.93697%	\$ 998.85	
	Hope- Welty Public Library	0.17971%	\$ 191.58	
	Oakley Cemetary	0.07841%	\$ 83.59	
	Oakley Township	0.96061%	\$ 1,024.05	
	Richland CC 537	0.39429%	\$ 420.33	
	W-O Mul-TP Asmt	0.03756%	\$ 40.04	Sum =
		<u>7.46031%</u>	<u>\$ 7,952.99</u>	\$ 7,952.99

2009	Tax Districts	Tax Rate		Crosscheck
	Cerro Gordo School #100	4.36051%	\$ 5,113.28	
<b>Total Assessed Value:</b>	Cerro Gordo Fire	0.15959%	\$ 187.14	
<b>\$ 117,263.43</b>	Co. Health & Mental Health	0.24488%	\$ 287.15	
	Conservation District	0.10019%	\$ 117.49	
	Cooperative Extension	0.02317%	\$ 27.17	
	County Tax	0.95288%	\$ 1,117.38	
	Hope- Welty Public Library	0.17933%	\$ 210.29	
	Oakley Cemetary	0.07685%	\$ 90.12	
	Oakley Township	0.94157%	\$ 1,104.12	
	Richland CC 537	0.39467%	\$ 462.80	
	W-O Mul-TP Asmt	0.03731%	\$ 43.75	Sum =
		<u>7.47095%</u>	<u>\$ 8,760.69</u>	\$ 8,760.69

2010	Tax Districts	Tax Rate		Crosscheck
Total Assessed Value: \$ 128,991.36	Cerro Gordo School #100	4.35974%	\$ 5,623.69	
	Cerro Gordo Fire	0.15597%	\$ 201.19	
	Co. Health & Mental Health	0.24449%	\$ 315.37	
	Conservation District	0.10150%	\$ 130.93	
	Cooperative Extension	0.02382%	\$ 30.73	
	County Tax	0.95958%	\$ 1,237.78	
	Hope- Welty Public Library	0.17563%	\$ 226.55	
	Oakley Cemetary	0.07954%	\$ 102.60	
	Oakley Township	0.97425%	\$ 1,256.70	
	Richland CC 537	0.43246%	\$ 557.84	
W-O Mul-TP Asmt	0.03945%	\$ 50.89	Sum =	
		7.54643%	\$ 9,734.24	\$ 9,734.24

2011	Tax Districts	Tax Rate		Crosscheck
Total Assessed Value: \$ 141,888.38	Cerro Gordo School #100	4.34194%	\$ 6,160.71	
	Cerro Gordo Fire	0.15475%	\$ 219.57	
	Co. Health & Mental Health	0.24173%	\$ 342.99	
	Conservation District	0.10127%	\$ 143.69	
	Cooperative Extension	0.02376%	\$ 33.71	
	County Tax	0.95558%	\$ 1,355.86	
	Hope- Welty Public Library	0.17840%	\$ 253.13	
	Oakley Cemetary	0.08000%	\$ 113.51	
	Oakley Township	0.99691%	\$ 1,414.50	
	Richland CC 537	0.47799%	\$ 678.21	
W-O Mul-TP Asmt	0.05103%	\$ 72.41	Sum =	
		7.60336%	\$ 10,788.28	\$ 10,788.28

2012	Tax Districts	Tax Rate		Crosscheck
Total Assessed Value: \$ 156,076.16	Cerro Gordo School #100	4.36420%	\$ 6,811.48	
	Cerro Gordo Fire	0.15082%	\$ 235.39	
	Co. Health & Mental Health	0.25260%	\$ 394.25	
	Conservation District	0.10713%	\$ 167.20	
	Cooperative Extension	0.02446%	\$ 38.18	
	County Tax	0.91349%	\$ 1,425.74	
	Hope- Welty Public Library	0.17224%	\$ 268.83	
	Oakley Cemetary	0.08000%	\$ 124.86	
	Oakley Township	1.01977%	\$ 1,591.62	
	Richland CC 537	0.48286%	\$ 753.63	
W-O Mul-TP Asmt	0.05113%	\$ 79.80	Sum =	
Macon County Mosq. Abatement	0.03319%	\$ 51.80	\$ 11,942.78	\$ 11,942.78
		7.65189%	\$ 11,942.78	

2013	Tax Districts	Tax Rate		
Total Assessed Value: \$ 171,681.66	Cerro Gordo School #100		\$ -	
	Cerro Gordo Fire		\$ -	
	Co. Health & Mental Health		\$ -	
	Conservation District		\$ -	
	Cooperative Extension		\$ -	
	County Tax		\$ -	
	Hope- Welty Public Library		\$ -	
	Oakley Cemetary		\$ -	
	Oakley Township		\$ -	
	Richland CC 537		\$ -	
W-O Mul-TP Asmt		\$ -		

0.00000% \$ -

2014	<u>Tax Districts</u>	<u>Tax Rate</u>	
	Cerro Gordo School #100	\$	-
	Cerro Gordo Fire	\$	-
	Co. Health & Mental Health	\$	-
	Conservation District	\$	-
	Cooperative Extension	\$	-
	County Tax	\$	-
	Hope- Welty Public Library	\$	-
	Oakley Cemetary	\$	-
	Oakley Township	\$	-
	Richland CC 537	\$	-
	W-O Mul-TP Asmt	\$	-
		0.00000%	\$ -

Total Assessed Value:	
\$ 188,853.00	

Property	Acreage	Total Tax Paid (2006 to 2014)										Total Paid by Parcel
		2006	2007	2008	2009	2010	2011	2012	2013	2014		
14-13-03-200-006	67.41	\$ 152.58	\$ 139.80	\$ 148.78	\$ 163.28	\$ 157.74	\$ 173.64	\$ 190.54	\$ -	\$ -	\$ -	\$ 1,126.36
14-13-03-200-008	119.84	\$ 458.98	\$ 467.10	\$ 498.74	\$ 549.64	\$ 303.32	\$ 336.12	\$ 370.28	\$ -	\$ -	\$ -	\$ 2,984.18
14-13-02-100-001	53.2	\$ 201.22	\$ 213.12	\$ 227.62	\$ 250.66	\$ 99.08	\$ 109.72	\$ 120.92	\$ -	\$ -	\$ -	\$ 1,222.34
14-13-02-100-006	100	\$ 486.84	\$ 526.16	\$ 561.84	\$ 618.82	\$ 288.80	\$ 320.04	\$ 352.68	\$ -	\$ -	\$ -	\$ 3,155.18
14-13-02-100-004	35	\$ 157.16	\$ 167.24	\$ 178.54	\$ 196.64	\$ 124.22	\$ 137.48	\$ 151.70	\$ -	\$ -	\$ -	\$ 1,112.98
14-13-02-200-002	36.22	\$ 166.06	\$ 172.16	\$ 183.90	\$ 202.54	\$ 154.02	\$ 170.54	\$ 188.12	\$ -	\$ -	\$ -	\$ 1,237.34
14-13-02-200-003	15.5	\$ 55.08	\$ 59.50	\$ 63.64	\$ 70.08	\$ 46.26	\$ 51.26	\$ 56.46	\$ -	\$ -	\$ -	\$ 402.28
14-13-02-200-013	59.03	\$ 200.28	\$ 213.66	\$ 228.14	\$ 251.26	\$ 68.98	\$ 76.42	\$ 84.20	\$ -	\$ -	\$ -	\$ 1,122.94
<b>Total Paid by Year</b>	<b>486.2</b>	<b>\$ 1,878.20</b>	<b>\$ 1,958.74</b>	<b>\$ 2,091.20</b>	<b>\$ 2,302.92</b>	<b>\$ 1,242.42</b>	<b>\$ 1,375.22</b>	<b>\$ 1,514.90</b>	<b>\$ -</b>	<b>\$ -</b>	<b>\$ -</b>	<b>\$ 12,363.60</b>

Oakley Silt Retention Basin Additional Tax/Use Calculation  
 (529 Acres)

2006	Tax Districts	Tax Rate	Amount Received	Amount Calculated	Difference Owed to Taxing Body
Total Tax Paid: \$ 1,878.20	Cerro Gordo School #100	4.63109%	1,113.61 \$	4,415.11 \$	3,301.51 \$
	Cerro Gordo Fire	0.18686%	44.93 \$	178.15 \$	133.21 \$
	Co. Health & Mental Health	0.23207%	55.80 \$	221.25 \$	165.44 \$
	Conservation District	0.10561%	25.40 \$	100.68 \$	75.29 \$
	Cooperative Extension	0.02589%	6.23 \$	24.68 \$	18.46 \$
	County Tax	0.94028%	226.10 \$	896.43 \$	670.33 \$
	Hope- Welty Public Library	0.18434%	44.33 \$	175.74 \$	131.42 \$
	Oakley Cemetery	0.08000%	19.24 \$	76.27 \$	57.03 \$
	Oakley Township	0.99929%	240.29 \$	952.69 \$	712.39 \$
	Richland CC 537	0.38678%	93.01 \$	368.74 \$	275.74 \$
	W-O Mul-TP Asmt	0.03855%	9.27 \$	36.75 \$	27.48 \$
		7.81076%	1,878.20 \$	7,446.50 \$	5,568.30 \$

2007	Tax Districts	Tax Rate	Amount Received	Amount Calculated	Difference Owed to Taxing Body
Total Tax Paid: \$ 1,958.74	Cerro Gordo School #100	4.53907%	1,156.84 \$	4,398.94 \$	3,242.10 \$
	Cerro Gordo Fire	0.17622%	44.91 \$	170.78 \$	125.87 \$
	Co. Health & Mental Health	0.23179%	59.07 \$	224.63 \$	165.56 \$
	Conservation District	0.10349%	26.38 \$	100.30 \$	73.92 \$
	Cooperative Extension	0.02459%	6.27 \$	23.83 \$	17.56 \$
	County Tax	0.94681%	241.31 \$	917.58 \$	676.27 \$
	Hope- Welty Public Library	0.18164%	46.29 \$	176.03 \$	129.74 \$
	Oakley Cemetery	0.07889%	20.11 \$	76.45 \$	56.35 \$
	Oakley Township	0.97112%	247.50 \$	941.14 \$	693.64 \$
	Richland CC 537	0.39411%	100.44 \$	381.94 \$	281.50 \$
	W-O Mul-TP Asmt	0.03775%	9.62 \$	36.58 \$	26.96 \$
		7.68548%	1,958.74 \$	7,448.21 \$	5,489.47 \$

2008	Tax Districts	Tax Rate	Amount Received	Amount Calculated	Difference Owed to Taxing Body
Total Tax Paid: \$ 2,091.20	Cerro Gordo School #100	4.33112%	1,214.06 \$	4,617.15 \$	3,403.09 \$
	Cerro Gordo Fire	0.16927%	47.45 \$	180.45 \$	133.00 \$
	Co. Health & Mental Health	0.24579%	68.90 \$	262.02 \$	193.12 \$
	Conservation District	0.10264%	28.77 \$	109.42 \$	80.65 \$
	Cooperative Extension	0.02394%	6.71 \$	25.52 \$	18.81 \$
	County Tax	0.93697%	262.64 \$	998.85 \$	736.21 \$
	Hope- Welty Public Library	0.17971%	50.37 \$	191.58 \$	141.20 \$
	Oakley Cemetery	0.07841%	21.98 \$	83.59 \$	61.61 \$
	Oakley Township	0.96061%	269.27 \$	1,024.05 \$	754.78 \$
	Richland CC 537	0.39429%	110.52 \$	420.33 \$	309.81 \$



Oakley Silt Retention Basin Additional Tax/Use Calculation  
 (529 Acres)

Amounts Owed to Each Body

W-O Mul-TP Asmt	0.03756%	\$ 10.53	\$ 40.04	\$ 29.51
	7.46031%	\$ 2,091.20	\$ 7,952.99	\$ 5,861.79

2009		Tax Districts			
Total Tax Paid:	\$ 2,302.92			Amount Calculated	Difference Owed to Taxing Body
		Cerro Gordo School #100	4.36051%	\$ 1,344.13	\$ 3,769.16
		Cerro Gordo Fire	0.15959%	\$ 49.19	\$ 137.95
		Co. Health & Mental Health	0.24488%	\$ 75.48	\$ 211.67
		Conservation District	0.10019%	\$ 30.88	\$ 86.60
		Cooperative Extension	0.02317%	\$ 7.14	\$ 20.03
		County Tax	0.95288%	\$ 293.73	\$ 823.65
		Hope- Welty Public Library	0.17933%	\$ 55.28	\$ 155.01
		Oakley Cemetery	0.07685%	\$ 23.69	\$ 66.43
		Oakley Township	0.94157%	\$ 290.24	\$ 813.88
		Richland CC 537	0.39467%	\$ 121.66	\$ 341.15
		W-O Mul-TP Asmt	0.03731%	\$ 11.50	\$ 32.25
			7.47095%	\$ 2,302.92	\$ 6,457.77

2010		Tax Districts			
Total Tax Paid:	\$ 1,242.42			Amount Calculated	Difference Owed to Taxing Body
		Cerro Gordo School #100	4.35974%	\$ 717.77	\$ 4,905.91
		Cerro Gordo Fire	0.15597%	\$ 25.68	\$ 175.51
		Co. Health & Mental Health	0.24449%	\$ 40.25	\$ 275.12
		Conservation District	0.10150%	\$ 16.71	\$ 114.22
		Cooperative Extension	0.02382%	\$ 3.92	\$ 26.80
		County Tax	0.95958%	\$ 157.98	\$ 1,079.79
		Hope- Welty Public Library	0.17563%	\$ 28.92	\$ 197.63
		Oakley Cemetery	0.07954%	\$ 13.10	\$ 89.50
		Oakley Township	0.97425%	\$ 160.40	\$ 1,096.30
		Richland CC 537	0.43246%	\$ 71.20	\$ 486.64
		W-O Mul-TP Asmt	0.03945%	\$ 6.49	\$ 44.39
			7.54643%	\$ 1,242.42	\$ 8,491.82

2011		Tax Districts			
Total Tax Paid:	\$ 1,375.22			Amount Calculated	Difference Owed to Taxing Body
		Cerro Gordo School #100	4.34194%	\$ 785.32	\$ 5,375.38
		Cerro Gordo Fire	0.15475%	\$ 27.99	\$ 191.58
		Co. Health & Mental Health	0.24173%	\$ 43.72	\$ 299.27
		Conservation District	0.10127%	\$ 18.32	\$ 125.37
		Cooperative Extension	0.02376%	\$ 4.30	\$ 29.42

Oakley Silt Retention Basin Additional Tax/Use Calculation  
 (529 Acres)

Amounts Owed to Each Body

County Tax	0.95588%	172.84	1,355.86	1,183.02
Hope- Welty Public Library	0.178409%	32.27	253.13	220.86
Oakley Cemetery	0.080000%	14.47	113.51	99.04
Oakley Township	0.996911%	180.31	1,414.50	1,234.19
Richland CC 537	0.477999%	86.45	678.21	591.76
W-O Mul-TP Asmt	0.051033%	9.23	72.41	63.18
	7.603366%	1,375.22	10,788.28	9,413.07

<b>2012</b>	<u>Tax Districts</u>	<u>Tax Rate</u>	<u>Amount Received</u>	<u>Amount Calculated</u>	<u>Difference Owed to Taxing Body</u>
	Cerro Gordo School #100	4.36420%	864.01	6,811.48	5,947.46
	Cerro Gordo Fire	0.15082%	29.86	235.39	205.54
	Co. Health & Mental Health	0.25260%	50.01	394.25	344.24
	Conservation District	0.10713%	21.21	167.20	146.00
	Cooperative Extension	0.02446%	4.84	38.18	33.33
	County Tax	0.91349%	180.85	1,425.74	1,244.89
	Hope- Welty Public Library	0.17224%	34.10	268.83	234.73
	Oakley Cemetery	0.08000%	15.84	124.86	109.02
	Oakley Township	1.01977%	201.89	1,591.62	1,389.73
	Richland CC 537	0.48286%	95.60	753.63	658.03
	W-O Mul-TP Asmt	0.05113%	10.12	79.80	69.68
	Macon Mosq. Abatement	0.03319%	6.57	51.80	45.23
		7.65189%	1,514.90	11,942.78	10,427.88

<b>2013</b>	<u>Tax Districts</u>	<u>Tax Rate</u>	<u>Amount Received</u>	<u>Amount Calculated</u>	<u>Difference Owed to Taxing Body</u>
	Cerro Gordo School #100		-	-	-
	Cerro Gordo Fire		-	-	-
	Co. Health & Mental Health		-	-	-
	Conservation District		-	-	-
	Cooperative Extension		-	-	-
	County Tax		-	-	-
	Hope- Welty Public Library		-	-	-
	Oakley Cemetery		-	-	-
	Oakley Township		-	-	-
	Richland CC 537		-	-	-
	W-O Mul-TP Asmt		-	-	-
		0.00000%	-	-	-

<b>2014</b>	<u>Tax Districts</u>	<u>Tax Rate</u>	<u>Amount Received</u>	<u>Amount Calculated</u>	<u>Difference Owed to Taxing Body</u>
-------------	----------------------	-----------------	------------------------	--------------------------	---------------------------------------

Prepared by: Christopher Siudyia  
 Erickson, Davis, Murphy, Johnson, and Walsh, Ltd.

Oakley Silt Retention Basin Additional Tax/Use Calculation  
 (529 Acres)

Amounts Owed to Each Body

- Cerro Gordo School #100
- Cerro Gordo Fire
- Co. Health & Mental Health
- Conservation District
- Cooperative Extension
- County Tax
- Hope- Welty Public Library
- Oakley Cemetery
- Oakley Township
- Richland CC 537
- W-O Mul-TP Asmt

Total Tax Paid: -  
 \$

\$	-
\$	-
\$	-
\$	-
\$	-
\$	-
\$	-
\$	-
\$	-
\$	-
\$	-
\$	-
0.000000%	-

**MACON COUNTY BOARD RESOLUTION  
REGARDING CASE S-02-12-13, A PETITION FOR SPECIAL USE  
PERMIT SUBMITTED BY Enbridge Energy, Limited Partnership**

**RESOLUTION NO. Z-1131-1-14**

**WHEREAS**, a petition was filed by Enbridge Energy, Limited Partnership requesting a Special Use Permit to construct a pump station and maintenance building for the pipeline in A-1 Agricultural zoning. The property is legally described as:

The North 1259.86 feet of the East 299.97 feet of the West Half of the Northwest Quarter of Section 25, Township 17 North, Range 1 East of the Third Principal Meridian, Situated in Macon County, Illinois, except coal and other minerals previously reserved or conveyed together with the right to mine and remove the same.

That part of the West ½ of the Northwest ¼ of Section 25, Township 17 North, Range 1 East of the Third Principal Meridian, Macon County, Illinois, described as follows: Commencing at an existing iron pin marking the Northeast corner of the West ½ of the Northwest ¼ of said Section 25; thence S. 89° 38' 35" W. -300.00 feet along the North line of the Northwest ¼ of said Section 25 to the point of beginning; thence S. 0° 29' 42" W. -680.00 feet along a line parallel with the East line of the West ½ of the Northwest ¼ of said Section 25; thence S. 89° 38' 35" W -360.00 feet along a line parallel with the North line of the Northwest ¼ of said Section 25; thence N. 0° 29' 42" E -680.00 feet along a line parallel with the East line of the West ½ of the Northwest ¼ of said Section 25 to a point on the North line of the Northwest ¼ of said Section 25; thence N. 89° 38' 35" E. -360.00 feet to the point of beginning. Said tract of land being subject to the right of way of Park Road along the North side thereof. (Except coal and other minerals previously reserved or conveyed and the right to mine and remove the same). Situated in Macon County, Illinois.

This property is commonly known as 5409 Park Rd., Warrensburg IL 62573 in Illini Township. PIN: 08-06-25-100-016.

**WHEREAS**, staff recommended at hearing the petition be granted with the following stipulations:

1. This Special Use Permit does not constitute a license issued to the name Petitioners only. This Special Use Permit is intended to "run with the land."
2. This Special Use Permit is assignable and/or transferable only upon the sale or transfer in ownership of the subject property.
3. Said property shall not be subdivided into two or more parts for the purpose of transfer of ownership or possession or for building development.
4. This pump station facility and all related structures, equipment, and appurtenances upon said property and all operations thereof shall be attenuated to a noise level plus or minus 10 percent of those levels specified in the table named "Noise Quality Analysis for Decatur Pumping Station related to Southern Access Expansion Project", "Est'd Sound Contribution of the Station" column,

on page "i" of the Report Summary of H&K Project No. 2181 dated December 10, 2007, a copy of which is hereby attached and incorporated by reference.

5. Equipment and appurtenances upon said property, specifically including but not limited to electrical motors and pumps, shall be enclosed in properly designed and constructed sound dampening structures with sufficient sound insulating properties to meet the criteria specified in stipulation number 4.

6. Said property and all operations upon said property shall remain subject to all other applicable local, County, State, and Federal regulations including, but not limited to, the Macon County Zoning Ordinance, the Macon County Nuisance Ordinance, and the Macon County Subdivision Ordinance.

7. This Special Use Permit shall be limited to 10 years and is subject to review at the end of that time. Special Use Permit expires January 9, 2024.

**WHEREAS**, at the required public hearing on December 4, 2013, your Zoning Board of Appeals heard the testimony presented and voted 5-0 in favor of recommending to the County Board the petition be granted subject to the 1 through 6 stipulations as set forth above with the exception of stipulation #7.

7. This Special Use Permit will be voided if construction does not begin within eighteen (18) months of approval of said permit by the Macon County Board. This permit will be reviewed periodically for compliance as frequently as is deemed necessary by the Macon County Zoning Administrator, but not less frequently than once every ten (10) years.

**WHEREAS**, on December 19, 2013, your EEHW Committee heard the summary report and hereby recommends by a 4-0 vote that the County Board approve the subject petition for a Special Use Permit to construct a pump station and maintenance building for the pipeline in a A-1 Agricultural zoning subject to the above stipulations recommended by the Zoning Board of Appeals and the below stipulations recommended by the EEHW Committee.

4. This pump station facility and all related structures, equipment, and appurtenances upon said property and all operations thereof shall be attenuated to a noise level not greater than 10 percent of those levels specified in the table named "Noise Quality Analysis for Decatur Pumping Station related to Southern Access Expansion Project", "Est'd Sound Contribution of the Station" column, on page "i" of the Report Summary of H&K Project No. 2943 dated December 13, 2013, a copy of which is hereby attached and incorporated by reference.

5. With the exception of the main line valve cluster, equipment and appurtenances upon said property, specifically including but not limited to electrical motors and pumps, shall be enclosed in properly designed and constructed sound dampening structures with sufficient sound insulating properties to meet the criteria specified in stipulation number 4.

**NOW, THEREFORE, BE IT RESOLVED** by the Macon County Board to approve the subject petition for a Special Use Permit to construct a pump station and maintenance building for the pipeline in a A-1 Agricultural zoning subject to the above stipulations recommended by the Zoning Board of Appeals.

**BE IT FURTHER RESOLVED** that this resolution shall become effective immediately upon the adoption thereof.

**PRESENTED, PASSED, APPROVED** this 9th day of January, 2014.

Ayes \_\_\_\_\_ NAYS \_\_\_\_\_

MACON COUNTY BOARD  
MACON COUNTY, ILLINOIS

ATTEST:

BY:

\_\_\_\_\_  
Stephen M. Bean, Clerk for the  
County of Macon, State of Illinois

\_\_\_\_\_  
Jay A. Dunn, Chairman  
Macon County Board

**Subject: Acoustical Assessment of the Proposed Decatur Pumping Station associated with an Enbridge Southern Access Expansion Project**

**Submitted to: Enbridge Energy, LP**  
1409 Hammond Ave.  
Superior, WI 54880-5247

H&K Report No. 2943

Date of Report: December 13, 2013

H&K Job No. 4712

Submitted by: Brian R. Hellebuyck, P.E., Hoover & Keith Inc.

**REPORT SUMMARY**

In this report, we present the results of an acoustical assessment for the proposed **Decatur (IL) Pumping Station** associated with the **Enbridge Energy Southern Access Expansion Project**. The purpose of the acoustical assessment is to project the sound contribution of the Decatur Pumping Station (referred to as "Station" in the report) and compare the results of the acoustical assessment to applicable sound criteria. In addition, noise control measures and equipment sound specifications are discussed, and the results of a recent ambient sound survey around the proposed site of the Station are included.

The following table summarizes the ambient noise environment around the Station (i.e., "lowest" measured ambient sound levels) and the estimated sound contribution of the Station at the nearby noise-sensitive areas (NSAs), which consist of primarily residences, during full load operation of the Station. The results in this table are defined as the "Noise Quality Analysis".

**Noise Quality Analysis for Decatur Pumping Station related to Southern Access Expansion Project**

Nearby NSAs and Type of NSA	Distance & Direction of NSA to Site Center	Lowest Meas'd Ambient A-Wt. Sound Level	Est'd Sound Contribution of the Station	Est'd Sound Level of Station plus Ambient Noise	Potential Noise Increase
NSA #1 (Residence)	1,300 feet (SW)	40.0 dBA	30.1 dBA	40.4 dBA	0.4 dB
NSA #2 (Residence)	2,950 feet (SSW)	38.7 dBA	21.8 dBA	38.8 dBA	0.1 dB
NSA #3 (Residence)	3,700 feet (NNW)	38.4 dBA	19.5 dBA	38.5 dBA	0.1 dB
NSA #4 (Residence)	4,200 feet (ENE)	46.1 dBA	18.2 dBA	46.1 dBA	0.0 dB

The acoustical assessment indicates that if the anticipated noise control measures are implemented (e.g., pumps enclosed inside an enclosure), the noise attributable to the Station is estimated to be significantly lower than State of IL Noise Requirements at the nearby NSAs (i.e., residences). In addition, the assessment indicates that the noise generated by the Station should have minimum to no impact on the surrounding acoustical environment.

**TABLE OF CONTENTS**

	<u>Page</u>
<b>1.0 INTRODUCTION</b> .....	1
<b>2.0 BRIEF DESCRIPTION OF THE STATION/EQUIPMENT</b> .....	1
<b>3.0 ACOUSTICAL TERMINOLOGY AND SOUND CRITERIA/REQUIREMENTS</b> .....	1
3.1 Acoustical Terminology and Example of Typical Environmental Sound Levels.....	1
3.2 State of Illinois Noise Regulations.....	2
3.3 Discussion of Noise Impact of a Noise Source.....	2
<b>4.0 MEASUREMENT LOCATIONS, METHODOLOGY AND MEASUREMENT RESULTS</b> .....	3
4.1 Sound Measurement Locations.....	3
4.2 Measurement Equipment and Data Acquisition .....	3
4.3 Results of Ambient Sound Survey.....	3
<b>5.0 ACOUSTICAL ASSESSMENT</b> .....	4
<b>6.0 NOISE CONTROL MEASURES AND/OR EQUIPMENT NOISE SPECIFICATIONS</b> .....	5
6.1 Enclosure Covering the Motors/Pumps.....	5
6.2 VFD/ESB and associated Components .....	6
<b>7.0 SUMMARY AND FINAL COMMENT</b> .....	6
<b>Figure 1:</b> General Area Layout showing Residences and Measurement Positions .....	7
<b>Figure 2:</b> Layout showing Closest NSA and Conceptual Layout of the Station .....	8
<b>Figure 3:</b> More Detailed Layout (Plot Plan) of the Pumping Station .....	9
<b>Table A:</b> Summary of Meas'd Ambient Sound Survey Data at the Nearby NSAs.....	10
<b>Table B:</b> Meteorological Conditions during the Sound Survey Tests .....	11
<b>Table C:</b> Meas'd Ambient Daytime A-Wt. Levels and O.B. SPLs .....	11
<b>Table D:</b> Meas'd Ambient Nighttime A-Wt. Levels and O.B. SPLs .....	11
<b>Table E:</b> Est'd Sound Contribution of the Station at Closest Residence (NSA #1) .....	12
<b>Table F:</b> Est'd Sound Contribution of the Station at next Closest NSA (NSA #2).....	13
<b>Table G:</b> Est'd Sound Contribution of the Station at NSA #3 .....	13
<b>Table H:</b> Est'd Sound Contribution of the Station at NSA #4 .....	13
<b>Figure 4:</b> Decatur Pumping Station: Area Layout with Est'd Sound Contours due to Operation of Station assuming Enclosure covering the Pumps.....	14
Description of the Acoustical Assessment Methodology and Source of Data .....	15
<b><u>Appendix:</u></b> Acoustical Terminology associated with Report, Typical Metrics for Regulating Environment Noise, List of Common Environmental (i.e., Man-Made & Natural) Noise Sources and a Chart with Sound Levels for Typical Activities.....	16-19



## 1.0 INTRODUCTION

In this report, we present the results of an acoustical assessment for the proposed **Decatur (IL) Pumping Station** associated with the **Enbridge Energy Southern Access Expansion Project**. For the project, there will be three (3) pumps, which includes one (1) spare, installed at the proposed Decatur Pumping Station (referred to as "Station" in the report). The purpose of the acoustical assessment is to project the sound contribution of the Station at the noise-sensitive areas (NSAs), such as residences, and compare the results of the acoustical assessment to applicable sound criteria. In addition, noise control measures and equipment sound specifications are discussed, and the results of a recent ambient sound survey around the proposed site of the Station are included.

## 2.0 BRIEF DESCRIPTION OF THE STATION/EQUIPMENT

**Figure 1** (p. 7) shows a general area layout around the Station showing the surrounding NSAs (i.e., primarily residences) and the reported sound measurement positions during the ambient sound survey. **Figure 2** (p. 8) provides a conceptual layout of equipment at the Station, and **Figure 3** (p. 9) shows a more detailed layout (plot plan) of the Station. The Station will be located in Macon County, Illinois, approximately 5.0 miles northwest of Decatur, IL. The closest residence (i.e., Class A Land) to the Station is located approximately 1,300 feet southwest of the Station site center (i.e., area of the pumps), and there are a few other residences located between 2,950 feet to 4,200 feet from the Station.

The Station will include three (3) 6,000 HP electric motor-driven pumps, which includes one (1) spare unit, electrical substation, variable frequency drive (VFD) and ESB. We understand that the motors/pumps and associated aboveground pump piping will be located inside a single insulated metal enclosure (i.e., Pump Enclosure). The new pumping equipment at a typical station will include a Sulzer centrifugal pump (i.e., Model HSB, operating at 1800 rpm) driven by a 6,000 HP Toshiba electric motor.

## 3.0 ACOUSTICAL TERMINOLOGY AND SOUND CRITERIA/REQUIREMENTS

### 3.1 Acoustical Terminology and Example of Typical Environmental Sound Levels

For the reader's information, a summary of acoustical terminology and list of typical metrics used to measure/regulate environmental noise is provided in the **Appendix** (pp. 16–18). There are several metrics for quantifying and regulating environmental noise level although the most common metric used by state and municipal agencies is the A-wt. sound level (i.e., dBA). There are also other metrics, such as  $L_{eq}$  and day-night average sound level (i.e.,  $L_{dn}$ ), that are used to correlate human reaction to an intruding sound. In addition, to gain an understanding and comparison of the predicted Station noise level, a **Table** is provided in the **Appendix** (p. 18) that shows a list of some common environmental noise sources compared to predicted Station noise

level at the closest NSAs along with a chart (**Appendix**, p. 19) that shows examples of sound levels for typical activities and expected community reaction.

3.2 State of Illinois Noise Regulations

There is an Illinois noise regulation that may apply to this type of facility, and the sound level limits in the regulation are maximum allowable unweighted octave-band (O.B.) sound pressure levels (SPLs) that should not be exceeded. Land usage classification is provided in Appendix B of these regulations, and in summary, residential property is classified as Class A Land, commercial property is classified as Class B Land and industrial/agriculture properties are classified as Class C. The applicable land usage areas for this site are interpreted as follows: (a) station is Class C Land (i.e., industrial), (b) any office building near the station is Class B Land, (c) any house (residence) near the station is Class A Land, and (c) farmland adjacent to any side of the station property is considered Class C Land (i.e., agricultural).

The maximum allowable unweighted SPLs from activities on Class C Land to Class B Land and on Class C Land to Class A Land is shown below in **Table 1** and it is assumed that these allowable O.B. SPLs would apply at any residence and/or office building near the station.

Condition	Unweighted SPL (in dB) per Octave Band Center Frequency (Hz)								
	31.5	63	125	250	500	1000	2000	4000	8000
Class C to Class B Daytime & Nighttime	80	79	74	69	63	57	52	48	45
Class C to Class A 07:00 to 22:00 hrs	75	74	69	64	58	52	47	43	40
Class C to Class A 22:00 to 07:00 hrs	69	67	62	54	47	41	36	32	32

**Table 1:** Allowable Maximum SPLs – State of IL Rules/Regulations (i.e., Class C to Class B & Class A)

Based on our interpretation of the IL State Noise Regulations, to comply with the IL regulations, we understand that the sound attributable to the facility must be below these SPLs in each unweighted O.B. SPL. Note that maximum allowable A-wt. sound levels are not given in the regulations although an approximate A-wt. sound level is **61 dBA** for Class C to Class A (daytime), **51 dBA** for Class C to Class A (nighttime) and **66 dBA** for Class C to Class B (daytime or nighttime). We are not aware of any applicable county (Macon County) noise regulations.

3.3 Discussion of Noise Impact of a Noise Source

It should also be noted that if the intruding noise (e.g., noise generated by the pumping station) causes less than a **3 dB** increase in the overall ambient noise level at the NSAs (i.e., defined as “potential noise increase”), the Station noise should be barely perceivable by the human ear and should have minimum impact on the acoustical environment. If the intruding noise causes an

increase in the overall ambient noise of between **4 dB** and **9 dB**, the noise of the Station may be audible by the human ear but should still have minimum impact on the acoustical environment.

#### **4.0 MEASUREMENT LOCATIONS, METHODOLOGY, AND MEASUREMENT RESULTS**

##### **4.1 Sound Measurement Locations**

Ambient sound levels were measured near the closest NSAs (i.e., residences) surrounding the Station (i.e., NSA #1, NSA #2, NSA #3 & NSA #4) and on the North Side of the anticipated Station property line. The following is a description of the nearby NSAs around the Station and the selected/reported sound measurement positions during the ambient sound survey:

- Pos. 1: Near NSA #1; a residence located approximately 1,300 feet SW of the Station site center (i.e., location of Pump Enclosure), and this NSA is considered the closest NSA to Station.
- Pos. 2: Near NSA #2; a residence located approximately 2,950 feet SSW of Station.
- Pos. 3: Near NSA #3; a residence located approximately 3,700 feet NNW of Station.
- Pos. 4: Near NSA #4; a residence located approximately 4,200 feet ENE of Station.
- Pos. 5: On the North Side of the anticipated Station property line.

##### **4.2 Measurement Equipment and Data Acquisition**

Sound measurements around the Station site were performed by Orlando Fernandez of H&K during the daytime and/or nighttime of Nov. 29-30, 2007. At each sound measurement position, the equivalent A-wt. sound level (i.e.,  $L_{eq}$ ) and unweighted octave-band (O.B.) sound pressure levels (i.e., SPLs) were measured at 5 feet above ground. Typically, several sample periods of the ambient noise were measured at each sound measurement position (e.g., 5 to 20 minutes in length). Sound measurements attempted to exclude "extraneous sound" such as cars or trucks passing immediately by the sound measurement location or other intermittent sources not typical of the ambient noise environment. The acoustical measurement system consisted of a Rion Model NA-27 Sound Level Meter (a Type 1 SLM per ANSI S1.4 & S1.11) equipped with a Rion Model UC-53A 1/2-inch condenser microphone/preamplifier with a windscreen. The SLM was calibrated with a microphone calibrator (calibrated within 1 year of the sound test date).

##### **4.3 Results of Ambient Sound Survey**

**Table A** (p. 10) summarizes the measured daytime  $L_{eq}$  (i.e.,  $L_d$ ) and measured/estimated nighttime  $L_{eq}$  (i.e.,  $L_n$ ) at the sound measurement locations near the nearby NSAs along with the average of the measured  $L_d$  and  $L_n$ . In addition, **Table A** includes the day-night average sound level (i.e.,  $L_{dn}$ ), as calculated from the measured  $L_d$  and measured/estimated  $L_n$ . Meteorological conditions during the sound survey are summarized in **Table B (Appendix, p. 10)**. The measured ambient daytime A-wt. sound levels and unweighted ambient O.B. SPLs during the sound survey are provided in **Table C** (p. 11), and the measured ambient nighttime A-wt. sound

levels and unweighted ambient O.B. SPLs, as measured only at NSA #1 and NSA #2, are provided in **Table D** (p. 11).

## 5.0 ACOUSTICAL ASSESSMENT

The noise assessment considers the noise produced by all equipment that could contribute to the noise generated by the facility, and the primary noise-generating equipment is located in the area of the pumps. The predicted sound contribution of the Station was performed only for the closest Class A Lands [i.e., closest residences, also referred to as NSAs]. For the noise assessment of the Station, the following equipment were considered significant and potential noise sources:

- 1) Noise of electric motor-driven product pumps;
- 2) Noise of aboveground piping (i.e., area of pumps);
- 3) Noise associated with the electrical substation (e.g., transformers, etc.);
- 4) Noise associated with the VFD Enclosure and ESB Enclosure.

**Table E** (p. 12) shows the spreadsheet calculation of the estimated A-wt. sound level and unweighted O.B. SPLs of the Station at the closest residence for standard day propagating conditions (i.e., no wind, 60 deg. F., 70% R.H.), and assumes that the pumps are enclosed. The estimated unweighted O.B. SPLs generated by the Station are also compared to the maximum nighttime O.B. SPLs for a Class A Land given in the State of IL Regulations, which is considered the most commonly applied noise limits in Illinois.

**Table F** (p. 13) provides the estimated A-wt. sound level and unweighted O.B. SPLs at the next closest NSA (i.e., NSA #2) based on the estimated Station sound level contribution at NSA #1, and the estimated unweighted O.B. SPLs generated by the Station are also compared to the maximum nighttime O.B. SPLs for a Class A Land given in the State of IL Regulations.

**Table G** (p. 13) provides the estimated A-wt. sound level and unweighted O.B. SPLs at the closest NSA located north of the Station (i.e., NSA #3) based on the Station sound level contribution at NSA #1, and the estimated unweighted O.B. SPLs generated by the Station are also compared to the maximum nighttime O.B. SPLs for a Class A Land given in the State of IL Regulations.

**Table H** (p. 13) provides the estimated A-wt. sound level and unweighted O.B. SPLs at the closest NSA located east of the Station (i.e., NSA #4) based on the Station sound level contribution at NSA #1, and the estimated unweighted O.B. SPLs generated by the Station are also compared to the maximum nighttime O.B. SPLs for a Class A Land given in the State of IL Regulations.

The following **Table 2** compares the maximum unweighted O.B. SPLs (IL State Regulations) with the predicted O.B. SPLs contributed by the Station at the closest residence (i.e., NSA #1) assuming that the pumps are enclosed, noting that the O.B. SPLs due to the Station at more

distant NSAs will be equal to or lower than the predicted Station sound level at the reported NSAs.

Condition or Related Noise Regulation	31.5 Hz	63 Hz	125 Hz	250 Hz	500 Hz	1000 Hz	2000 Hz	4000 Hz	8000 Hz
Est'd O.B. SPLs of Station at closest residence	46	45	38	34	27	21	16	8	0
State of IL allowable nighttime O.B. SPLs	69	67	62	54	47	41	36	32	32

**Table 2:** Est'd Unweighted O.B. SPLs of the Station at the Closest Residence (i.e., NSA #1) compared to the Maximum Allowable Nighttime O.B. SPLs given in the State of IL Regulations

Based on the results of this acoustical assessment, the noise generated by the Station at all nearby NSAs should be well below the maximum unweighted O.B. SPLs specified in the IL State Noise Requirement for a Class A Lands (i.e., residences).

For reference, **Figure 4** (p. 14), shows an area layout around the proposed Decatur Pumping Station with sound contours showing the estimated A-wt. sound levels resulting from operation of the Station (assuming the pumps are enclosed) at distances of 500 feet, 1,000 feet and 2,000 feet.

A description of the acoustical assessment methodology and the source of sound data are provided toward the end of the report (p. 15).

**6.0 NOISE CONTROL MEASURES AND EQUIPMENT NOISE SPECIFICATIONS**

The following section provides the recommended noise control measures for the significant sound sources associated with the Station and equipment sound level requirements (if applicable) along with other assumptions that may affect the noise generated by the Station.

**6.1 Enclosure Covering the Motors/Pumps**

We understand that the motors/pumps will be installed inside an enclosure (i.e., Pump Enclosure). The following describes specific requirements related to components of the Pump Enclosure.

- As a minimum, walls/roof should be constructed with an exterior skin of 24-gauge metal, and enclosure interior surfaces should be covered with a minimum of 2-inch thick "high-density" mineral wool (i.e., 6.0-8.0 pcf uniform density) covered with a perforated liner or other type of protective liner. Windows should not be installed in the enclosure and all voids/openings in the walls/roof resulting from penetrations of ducts, piping should be patched and well sealed.
- Personnel entry doors should seal well when closed. For the "large" access door systems (i.e., "roll-up" doors), it is recommended to employ an insulated-type roll-up doors (e.g., 22-ga.

exterior facing, 24-ga. backskin door with insulation core), and the roll-up door should seal well when closed.

- Regarding the enclosure air ventilation system, it is anticipated that the air ventilation system be designed with air supply fans mounted in enclosure wall(s) along with a roof-mounted air exhaust vent/system to exhaust the air. Assuming this ventilation design, the sound level for each wall supply fan should not exceed **50 dBA at 50 feet**, which may require that each air supply fan employ an exterior silencer and/or acoustically-lined weatherhood. The roof exhaust vent/system is expected to be designed with a "low-profile" roof ridge vent. Wall louvers are not recommended but if employed, acoustical-type louvers should be utilized.

6.2 VFD/ESB and associated Components

The A-wt. sound level of equipment associated with the VFD and ESB enclosure should not exceed **60 dBA** at a distance of **50 feet** from the outside equipment during operation (i.e., operation of equipment/enclosure cooling fans and enclosure AC units). This may require that "low-noise" cooler fans be employed that operate at low fan tip speeds (e.g., below 9,000 fpm). Specialized noise control measures are not anticipated for transformers and substation equipment.

7.0 SUMMARY AND FINAL COMMENT

The following **Table 3** summarizes the measured ambient noise environment around the site of the Station and the estimated sound contribution of the Station at the nearby noise-sensitive areas (NSAs), such as residences, during full load operation of the Station. The results in this table are defined as the "Noise Quality Analysis".

Nearby NSAs and Type of NSA	Distance & Direction of NSA to Site Center	Lowest Meas'd Ambient A-Wt. Sound Level	Est'd Sound Contribution of the Station	Est'd Sound Level of Station plus Ambient Noise	Potential Noise Increase
NSA #1 (Residence)	1,300 feet (SW)	40.0 dBA	30.1 dBA	40.4 dBA	0.4 dB
NSA #2 (Residence)	2,950 feet (SSW)	38.7 dBA	21.8 dBA	38.8 dBA	0.1 dB
NSA #3 (Residence)	3,700 feet (NNW)	38.4 dBA	19.5 dBA	38.5 dBA	0.1 dB
NSA #4 (Residence)	4,200 feet (ENE)	46.1 dBA	18.2 dBA	46.1 dBA	0.0 dB

**Table 3:** Noise Quality Analysis for Decatur Pumping Station related to Southern Access Expansion Project

The acoustical assessment indicates that if the anticipated noise control measures are implemented (e.g., pumps enclosed inside an enclosure), the noise attributable to the proposed **Decatur Pumping Station** is estimated to be significantly lower than State of IL Noise Requirements at the nearby residences. In addition, the assessment indicates that the potential noise increase in the ambient noise level due to the Station should be less than **3 dB** at the nearby NSAs (i.e., residences). Consequently, the noise of the Station may be only barely perceivable by the human ear, and therefore, should have minimum or no impact on the surrounding acoustical environment.

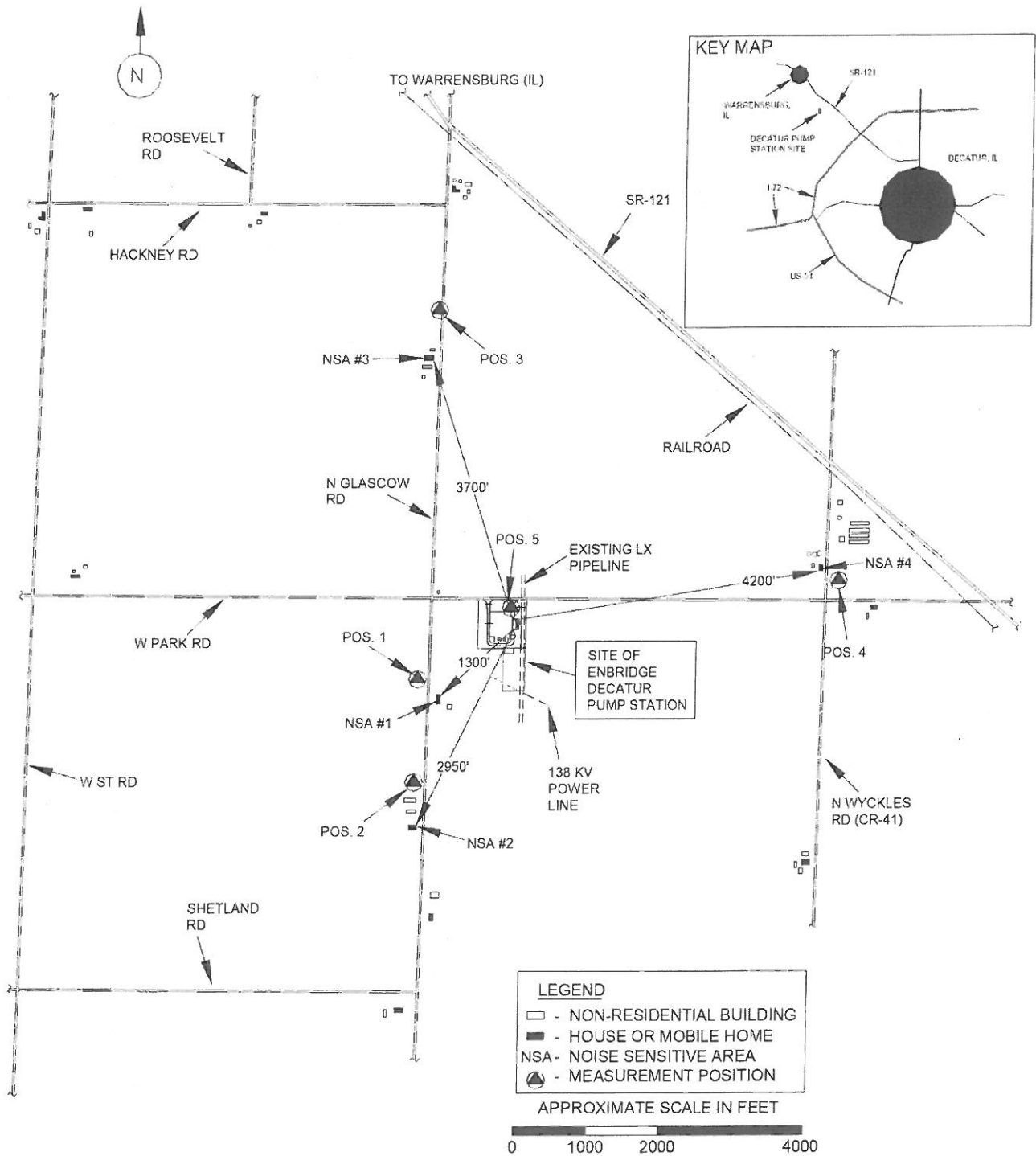
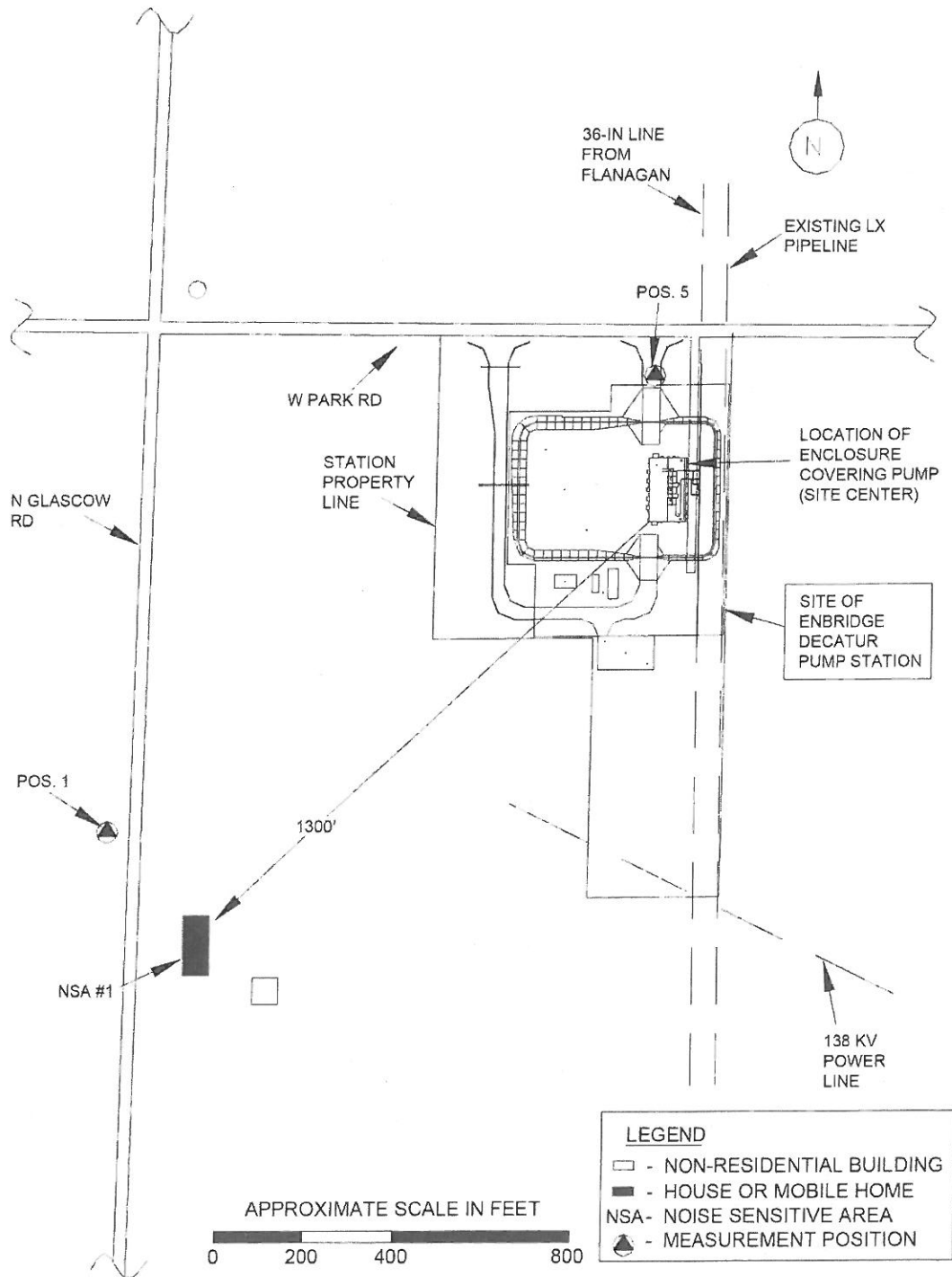

Figure 1: Enbridge Decatur Pumping Station: General Area Layout showing the NSAs (i.e., Residences) around the Station and Sound Survey Measurement Positions.





**Figure 2:** Enbridge Decatur Pumping Station: Layout around the Station showing the Closest Residence and Conceptual Layout (Plot Plan) of the Pumping Station



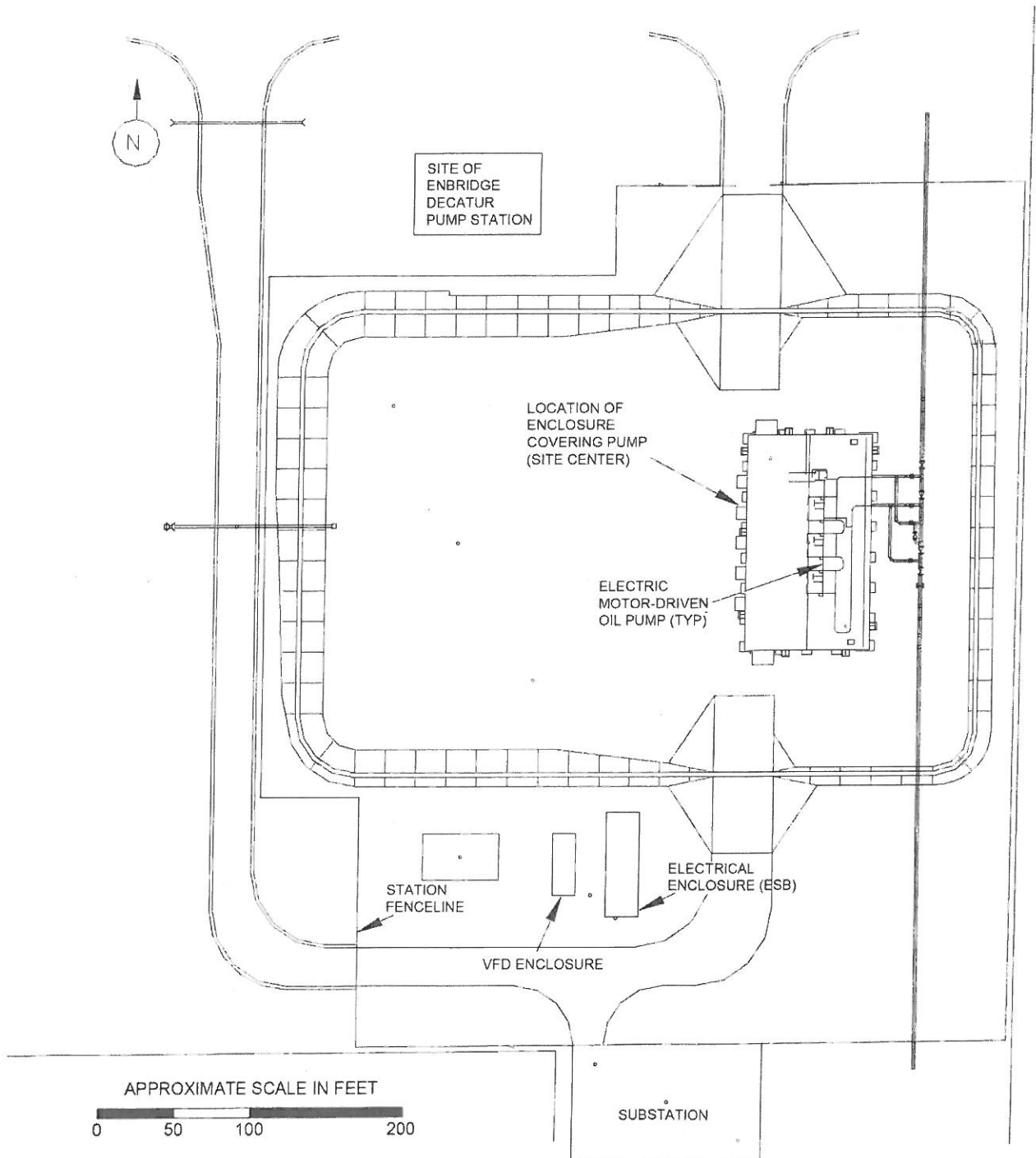

Figure 3: Enbridge Decatur Pumping Station: More Detailed Layout (Plot Plan) of the Equipment for the Station and Anticipated Station Property Line.

Measurement Position	Measured A-Weighted (A-Wt.) Sound Levels (dBA)							Notes/Observations
	D-time Leq (Ld)	Time	Avg. Ld	N-time Leq (Ln)	Time	Avg. Ln	Calc'd Ldn	
Pos. 1 (NSA #1) Residence on N. Glasgow Road, 1,300 Ft. SW of Site	37.9	2:38 PM	40.0	48.0	8:35 PM	47.4	53.3 Note (2)	During <u>daytime</u> : Primarily noise of the wind. Also, the noise produces by the traffic on the surrounding roads, noise of a distant aircraft.
	42.2	2:47 PM		46.9	8:50 PM			During <u>nighttime</u> : Primarily noise of the wind. Also, the noise vehicle traffic
Pos. 2 (NSA #2) Residence on N. Glasgow Road, 2,950 Ft. SSW of Site	38.0	4:28 PM	38.7	38.7 Note (1)	N/A	38.7 Note (1)	45.1 Note (2)	During <u>daytime</u> : Primarily noise the sound of birds. Also, noise of wind in trees, sound of farm animals and noise vehicle traffic.
	39.5	4:36 PM						
Pos. 3 (NSA #3) Residence on N. Glasgow Road, 3,700 Ft. NNW of Site	39.4	3:10 PM	38.7	39.1	9:11 PM	38.4	44.9 Note (2)	During <u>daytime</u> : Primarily noise of the wind. Also, the noise produces by the traffic on the surrounding roads.
	38.4	3:28 PM		37.9	9:28 PM			During <u>nighttime</u> : Primarily noise of the wind. Also, the noise vehicle traffic
Pos. 4 (NSA #4) Residence on N. Wyckles Road, 4,200 Ft. ENE of Site	47.0	7:08 AM	46.1	46.1 Note (1)	N/A	46.1 Note (1)	52.5 Note (2)	During <u>daytime</u> : Primarily noise the sound of birds. Also, noise of vehicle traffic.
	45.4	7:21 AM						

**Table A: Proposed Enbridge Decatur Pumping Station: Summary of the Measured Ambient Daytime and Ambient Nighttime Sound Levels at the Nearby NSAs on November 29-30, 2007 along with the Calculated Ambient Ldn (as calculated via Ambient Ld & Ln).**

Note (1): Although nighttime levels (Ln) were not measured at this location, ambient nighttime A-wt. sound levels should be similar to or equal to the measured daytime sound levels.

Note (2): If both Ld and Ln are measured and/or estimated, Ldn is calculated using the following formula:

$$L_{dn} = 10 \log_{10} \left( \frac{15}{24} 10^{L_d/10} + \frac{9}{24} 10^{(L_n+10)/10} \right)$$

Measurement Set		Temp. (°F)	R.H. (%)	Wind Direction	Wind Speed	Peak Wind	Sky Conditions
Position	Date/Time of Testing						
Pos. 1, 2, 3 & 5	2:00 PM to 5:00 PM 11/29/07 (Daytime Tests)	34-38	26-39	Wind from West NW	1-4 mph	3-8 mph	Mostly clear sky
Pos. 1 & 3	8:30 PM to 9:30 PM 11/29/07 (Nighttime Tests)	31-32	28-29	Wind from West NW	2-3 mph	5-6 mph	Mostly clear sky
Pos. 4	7:00 AM to 8:00 AM 11/30/07 (Daytime Tests)	27	26	Wind from West NW	2 mph	4 mph	Mostly clear sky

**Table B: Proposed Enbridge Decatur Pumping Station: Meteorological Conditions During the Ambient Sound Survey Measurements around the Station Site on Nov. 29-30, 2007.**

Measurement Set		Sound Pressure Level (SPL) in dB per Octave-Band (O.B.) Frequency (in Hz)									A-Wt.
Position	Time/Date	31.5	63	125	250	500	1000	2000	4000	8000	Level
Pos. 1 (NSA #1) Residence on N. Glasgow Road, 1,300 Ft. SW of Site	2:38 PM (11/29/07)	64.1	52.5	44.0	37.1	33.1	31.4	28.3	27.5	21.5	37.9
	2:47 PM (11/29/07)	67.1	57.7	51.3	42.1	38.1	33.6	31.1	30.9	26.7	42.2
	<b>Average SPL</b>	<b>65.6</b>	<b>55.1</b>	<b>47.7</b>	<b>39.6</b>	<b>35.6</b>	<b>32.5</b>	<b>29.7</b>	<b>29.2</b>	<b>24.1</b>	<b>40.0</b>
Pos. 2 (NSA #2) Residence on N. Glasgow Road, 2,950 Ft. SSW of Site	4:28 PM (11/29/07)	51.6	49.4	36.5	29.8	30.4	33.6	33.3	22.0	22.9	38.0
	4:36 PM (11/29/07)	50.4	49.0	33.8	26.9	32.0	33.6	36.1	21.7	20.0	39.5
	<b>Average SPL</b>	<b>51.0</b>	<b>49.2</b>	<b>35.2</b>	<b>28.4</b>	<b>31.2</b>	<b>33.6</b>	<b>34.7</b>	<b>21.9</b>	<b>21.5</b>	<b>38.7</b>
Pos. 3 (NSA #3) Residence on N. Glasgow Road, 3,700 Ft. NNW of Site	3:10 PM (11/29/07)	64.4	55.8	45.1	34.9	32.9	32.6	32.1	28.9	25.8	39.4
	3:28 PM (11/29/07)	61.8	53.4	42.2	38.9	33.4	33.2	28.8	26.2	22.8	38.4
	<b>Average SPL</b>	<b>63.1</b>	<b>54.6</b>	<b>43.7</b>	<b>36.9</b>	<b>33.2</b>	<b>32.9</b>	<b>30.5</b>	<b>27.6</b>	<b>24.3</b>	<b>38.7</b>
Pos. 4 (NSA #4) Residence on N. Wyckles Road, 4,200 Ft. ENE of Site	7:08 AM (11/30/07)	64.4	58.9	52.6	48.6	45.1	38.1	38.0	33.9	29.1	47.0
	7:21 AM (11/30/07)	63.8	60.1	51.8	48.6	40.0	38.0	35.7	32.1	28.4	45.4
	<b>Average SPL</b>	<b>64.1</b>	<b>59.5</b>	<b>52.2</b>	<b>48.6</b>	<b>42.6</b>	<b>38.1</b>	<b>36.9</b>	<b>33.0</b>	<b>28.8</b>	<b>46.1</b>
Pos. 5 N. Side Property Line of Pumping Station Site	2:02 PM (11/29/07)	64.6	59.4	53.6	48.4	45.4	39.5	38.0	34.9	29.6	47.5
	2:16 PM (11/29/07)	63.4	53.2	43.2	36.1	36.1	38.0	34.7	32.9	29.4	42.3
	<b>Average SPL</b>	<b>64.0</b>	<b>56.3</b>	<b>48.4</b>	<b>42.3</b>	<b>40.8</b>	<b>38.8</b>	<b>36.4</b>	<b>33.9</b>	<b>29.5</b>	<b>44.5</b>

Table C: Proposed Enbridge Decatur Pumping Station: Meas'd Ambient Daytime Unweighted O.B. SPLs and A-Wt. Sound Levels as Meas'd in Afternoon of Nov. 29 ('07) or Morning of Nov. 30 ('07).

Measurement Set		Sound Pressure Level (SPL) in dB per Octave-Band (O.B.) Frequency (in Hz)									A-Wt.
Position	Time/Date	31.5	63	125	250	500	1000	2000	4000	8000	Level
Pos. 1 (NSA #1) Residence on N. Glasgow Road, 1,300 Ft. SW of Site	8:35 PM (11/29/07)	64.7	59.8	53.7	49.1	46.0	40.0	38.6	35.1	28.1	48.0
	8:50 PM (11/29/07)	64.0	58.3	53.2	49.0	45.4	38.0	36.1	33.6	26.4	46.9
	<b>Average SPL</b>	<b>64.4</b>	<b>59.1</b>	<b>53.5</b>	<b>49.1</b>	<b>45.7</b>	<b>39.0</b>	<b>37.4</b>	<b>34.4</b>	<b>27.3</b>	<b>47.4</b>
Pos. 3 (NSA #3) Residence on N. Glasgow Road, 3,700 Ft. NNW of Site	9:11 PM (11/29/07)	63.6	54.9	44.6	40.1	31.1	32.1	30.6	29.1	25.0	39.1
	9:28 PM (11/29/07)	61.0	52.1	42.0	40.6	32.8	30.9	28.6	25.9	21.7	37.9
	<b>Average SPL</b>	<b>62.3</b>	<b>53.5</b>	<b>43.3</b>	<b>40.4</b>	<b>32.0</b>	<b>31.5</b>	<b>29.6</b>	<b>27.5</b>	<b>23.4</b>	<b>38.4</b>

Table D: Proposed Enbridge Decatur Pump Station: Meas'd Ambient Nighttime Unweighted O.B. SPLs and A-Wt. Sound Levels as Meas'd in Nighttime of Nov. 29 ('07).

Source No. & Dist (Ft)	Noise Sources and Other Conditions/Factors associated with Acoustical Analysis	PWL or SPL in dB Per Octave-Band Center Frequency (Hz)									A-Wt. Level
		31.5	63	125	250	500	1000	2000	4000	8000	
1)	PWL of Unenclosed Pumps (2 Units)	108	110	108	108	106	102	100	98	95	108
	Atten. of Additional Noise Control (Enclosure)	-4	-6	-12	-15	-20	-25	-28	-30	-30	
	Misc. Atten. (Shielding or Ground Effect)	0	0	0	0	0	0	0	0	0	
	1300 Hemispherical Radiation	-60	-60	-60	-60	-60	-60	-60	-60	-60	
	1300 Atm. Absorption (70% R.H., 60 deg F)	0	0	0	-1	-1	-2	-4	-10	-18	
	1300 Source Sound Level Contribution	44	44	36	33	25	15	8	0	0	
2)	PWL of Aboveground Piping (2 Units)	105	102	100	98	95	94	92	90	88	100
	Atten. of Additional Noise Control (Enclosure)	-4	-6	-12	-15	-20	-25	-28	-30	-30	
	Misc. Atten. (Shielding or Ground Effect)	0	0	0	0	0	0	0	0	0	
	1300 Hemispherical Radiation	-60	-60	-60	-60	-60	-60	-60	-60	-60	
	1300 Atm. Absorption (70% R.H., 60 deg F)	0	0	0	-1	-1	-2	-4	-10	-18	
	1300 Source Sound Level Contribution	41	36	28	23	14	7	0	0	0	
3)	PWL of Electrical Substation	85	90	92	85	80	75	70	65	60	83
	Atten. of Additional Noise Control	0	0	0	0	0	0	0	0	0	
	Misc. Atten. (Shielding or Ground Effect)	0	0	0	0	0	0	0	0	0	
	1300 Hemispherical Radiation	-60	-60	-60	-60	-60	-60	-60	-60	-60	
	1300 Atm. Absorption (70% R.H., 60 deg F)	0	0	0	-1	-1	-2	-4	-10	-18	
	1300 Source Sound Level Contribution	25	30	32	25	19	13	6	0	0	
4)	PWL of VFD & ESB for the Pumps	90	92	86	86	82	80	78	75	70	86
	Atten. of Additional Noise Control	0	0	0	0	0	0	0	0	0	
	Misc. Atten. (Shielding or Ground Effect)	0	0	0	0	0	0	0	0	0	
	1300 Hemispherical Radiation	-60	-60	-60	-60	-60	-60	-60	-60	-60	
	1300 Atm. Absorption (70% R.H., 60 deg F)	0	0	0	-2	-1	-2	-4	-10	-18	
	1300 Source Sound Level Contribution	30	32	28	24	21	18	14	5	0	
Est'd Total Sound Contribution of Sources at NSA #1		46	45	38	34	27	21	16	8	0	30.1
Allowable Max. Nighttime O.B. SPLs of IL State Regulations		69	67	62	54	47	41	36	32	32	51.0
Meas'd Lowest Ambient A-Wt. Sound Level at NSA #1										40.0	
Sound Contribution of Station Plus Lowest Ambient A-Wt. Level										40.4	
Potential Increase above Lowest Ambient Noise (dB)										0.4	

Table E: Enbridge Decatur Pumping Station: Est'd Sound Contribution of Pumping Station at Closest Class A Land (i.e., NSA #1, a Residence located approx. 1,300 Ft. SW of Pumps) assuming Operation of Two (2) 6,000 HP Motor-Driven Pumps (i.e., Motors/Pumps & Aboveground Piping covered with Enclosure). Included is the Noise Increase above the Typical Ambient Sound Level due to Station Operation.

Note: Est'd Sound Contribution of Station compared to the Allowable Maximum Nighttime Unweighted O.B. SPLs of the State of IL Regulations (i.e., Industrial Noise Emitted to Residential Received Limits), which are the Most Commonly Applied Noise Limits in Illinois.

NOTE: Muffler DIL & Equipment PWL values on this spreadsheet should not be used as the specified values. Refer to "Noise Control Measures" section in report or other company specifications for actual specified values.

Source No. & Dist (Ft)	Noise Sources and Other Conditions/Factors associated with Acoustical Analysis	SPL in dB Per O.B. Center Frequency (Hz)									A-Wt. Level
		31.5	63	125	250	500	1000	2000	4000	8000	
	Est'd SPLs of Station at 1300 Ft. (RE: Table D)	46	45	38	34	27	21	16	8	0	30.1
2950	Hemisph Radiation [20*log(2950/1300) = 7.1 dB]	-7.1	-7.1	-7.1	-7.1	-7.1	-7.1	-7.1	-7.1	-7.1	
2950	Atm. Absorption (70% R.H., 60 deg F)	0	0	0	-1	-1	-3	-6	-15	-27	
<b>Est'd Total Sound Contribution of Station at NSA #2</b>		<b>39</b>	<b>38</b>	<b>31</b>	<b>26</b>	<b>19</b>	<b>11</b>	<b>3</b>	<b>0</b>	<b>0</b>	<b>21.8</b>
Allowable Max. Nighttime O.B. SPLs of IL State Regulations		<b>69</b>	<b>67</b>	<b>62</b>	<b>54</b>	<b>47</b>	<b>41</b>	<b>36</b>	<b>32</b>	<b>32</b>	<b>51.0</b>
<b>Meas'd Lowest Ambient A-Wt. Sound Level at NSA #2</b>											<b>38.7</b>
Sound Contribution of Station Plus Lowest Ambient A-Wt. Level											38.8
Potential Increase above Lowest Ambient Noise (dBE)											0.1

**Table F: Enbridge Decatur Pumping Station: Est'd Sound Contribution of Pumping Station at Next Closest NSA (i.e., NSA #2, Residence located approx. 2,950 Ft. SSW of the Pumps) assuming Operation of Two (2) 6,000 HP Motor-Driven Pumps (i.e., Motors/Pumps & Aboveground Piping covered with Enclosure). Included is the Noise Increase above the Typical Ambient Sound Level due to Station Operation.**

Source No. & Dist (Ft)	Noise Sources and Other Conditions/Factors associated with Acoustical Analysis	SPL in dB Per O.B. Center Frequency (Hz)									A-Wt. Level
		31.5	63	125	250	500	1000	2000	4000	8000	
	Est'd SPLs of Station at 1300 Ft. (RE: Table D)	46	45	38	34	27	21	16	8	0	30.1
3700	Hemisph Radiation [20*log(3700/1300) = 9.1 dB]	-9.1	-9.1	-9.1	-9.1	-9.1	-9.1	-9.1	-9.1	-9.1	
3700	Atm. Absorption (70% R.H., 60 deg F)	0	0	-1	-1	-2	-4	-8	-21	-37	
<b>Est'd Total Sound Contribution of Station at NSA #3</b>		<b>37</b>	<b>36</b>	<b>28</b>	<b>24</b>	<b>17</b>	<b>8</b>	<b>0</b>	<b>0</b>	<b>0</b>	<b>19.5</b>
Allowable Max. Nighttime O.B. SPLs of IL State Regulations		<b>69</b>	<b>67</b>	<b>62</b>	<b>54</b>	<b>47</b>	<b>41</b>	<b>36</b>	<b>32</b>	<b>32</b>	<b>51.0</b>
<b>Meas'd Lowest Ambient A-Wt. Sound Level at NSA #3</b>											<b>38.4</b>
Sound Contribution of Station Plus Lowest Ambient A-Wt. Level											38.5
Potential Increase above Lowest Ambient Noise (dBE)											0.1

**Table G: Enbridge Decatur Pumping Station: Est'd Sound Contribution of Pumping Station at NSA #3 (i.e., Residence located approx. 3,700 Ft. NNW of the Pumps) assuming Operation of the Two (2) 6,000 HP Motor-Driven Pumps (i.e., Motors/Pumps & Aboveground Piping covered with Enclosure). Included is the Noise Increase above the Typical Ambient Sound Level due to Station Operation.**

Source No. & Dist (Ft)	Noise Sources and Other Conditions/Factors associated with Acoustical Analysis	SPL in dB Per O.B. Center Frequency (Hz)									A-Wt. Level
		31.5	63	125	250	500	1000	2000	4000	8000	
	Est'd SPLs of Station at 1300 Ft. (RE: Table D)	46	45	38	34	27	21	16	8	0	30.1
4200	Hemisph Radiation [20*log(4200/1000) = 10.2 dB]	-10.2	-10.2	-10.2	-10.2	-10.2	-10.2	-10.2	-10.2	-10.2	
4200	Atm. Absorption (70% R.H., 60 deg F)	0	0	-1	-1	-2	-5	-10	-24	-44	
<b>Est'd Total Sound Contribution of Station at NSA #4</b>		<b>35</b>	<b>34</b>	<b>27</b>	<b>22</b>	<b>15</b>	<b>6</b>	<b>0</b>	<b>0</b>	<b>0</b>	<b>18.2</b>
Allowable Max. Nighttime O.B. SPLs of IL State Regulations		<b>69</b>	<b>67</b>	<b>62</b>	<b>54</b>	<b>47</b>	<b>41</b>	<b>36</b>	<b>32</b>	<b>32</b>	<b>51.0</b>
<b>Meas'd Lowest Ambient A-Wt. Sound Level at NSA #4</b>											<b>46.1</b>
Sound Contribution of Station Plus Lowest Ambient A-Wt. Level											46.1
Potential Increase above Lowest Ambient Noise (dBE)											0.0

**Table H: Enbridge Decatur Pumping Station: Est'd Sound Contribution of Pumping Station at NSA #4 (i.e., Residence located approx. 4,200 Ft. ENE of the Pumps) assuming Operation of the Two (2) 6,000 HP Motor-Driven Pumps (i.e., Motors/Pumps & Aboveground Piping covered with Enclosure). Included is the Noise Increase above the Typical Ambient Sound Level due to Station Operation.**

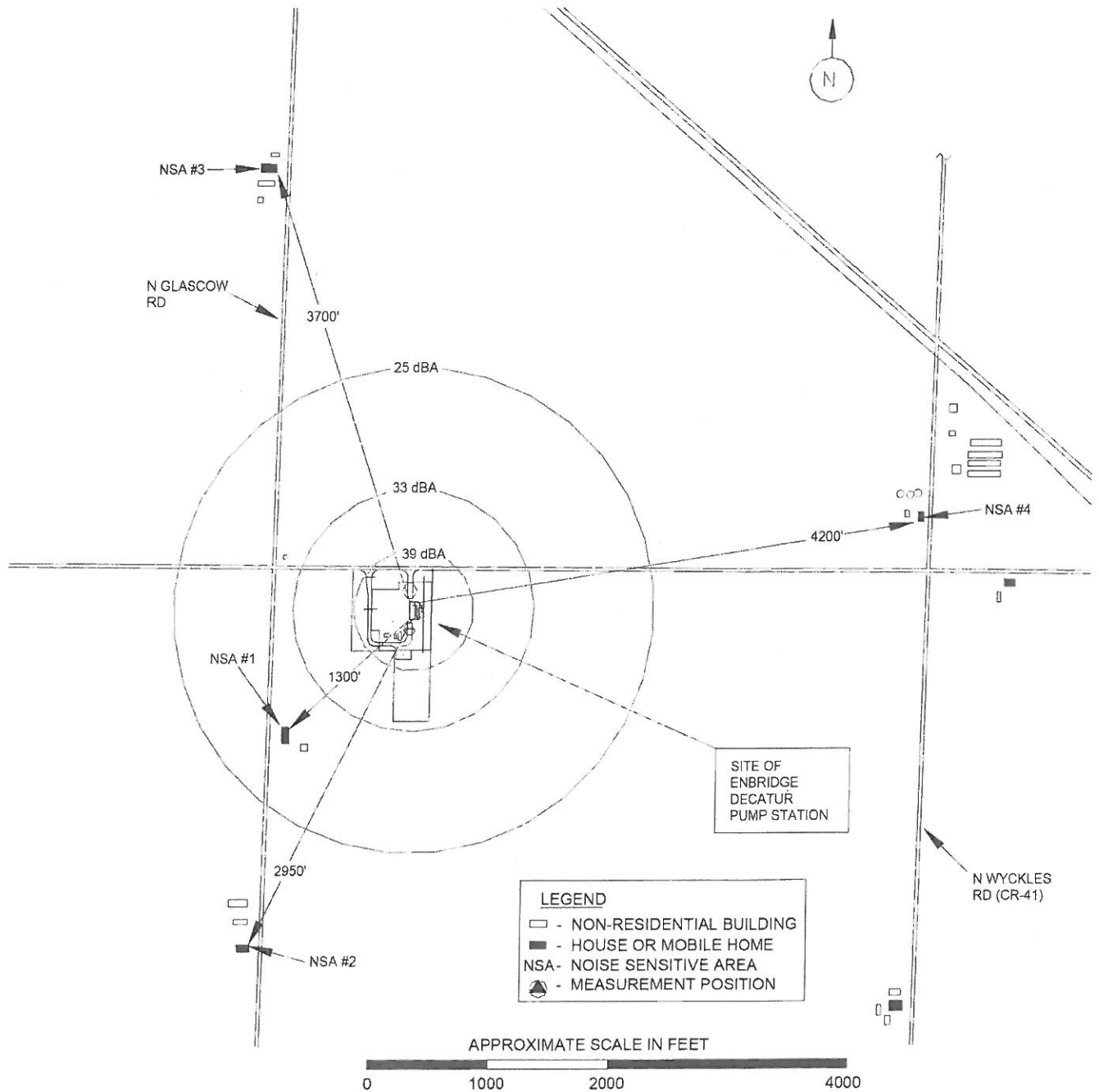

**Figure 4:** Enbridge Decatur Pumping Station: Area Layout with Est'd Sound Contours due to Full Load Operation of Pumping Station assuming Enclosure covering the Pumps



## ANALYSIS METHODOLOGY AND SOURCE OF SOUND DATA

In general, the predicted sound level contributed by the pumping station equipment was calculated as a function of frequency from estimated unweighted octave-band (O.B.) sound power levels (PWLs) for each significant sound source. The following summarizes the acoustical analysis procedure for the Station:

- Initially, unweighted O.B. PWL values of the significant noise sources were determined from equipment manufacturer's sound data and/or actual sound level measurements performed by H&K at similar type of equipment/components expected for this facility.
- Then, expected noise reduction (NR) or attenuation in dB per O.B. frequency due to any noise control measures, hemispherical sound propagation (discussed in more detail below\*) and atmospheric sound absorption (discussed in more detail below\*\*) were subtracted from the unweighted octave-band PWLs to obtain the unweighted O.B. SPLs of each noise source. Since sound shielding by buildings and/or enclosures can influence the sound level contributed at the NSAs, we also included the sound shielding due to buildings, if appropriate. The sound attenuation effect due to foliage or land contour was not considered in the analysis although there probably will be some attenuation due to foliage/trees.
- Finally, the resulting estimated unweighted O.B. SPLs for all noise sources associated with the Station (with noise control and other sound attenuation effects) were logarithmically summed, and the total O.B. SPLs for all noise sources were corrected for A-weighting to provide the estimated overall A-wt. sound level contributed by the Station at the closest NSA. The predicted sound contribution of the Station at the closest NSA was utilized to estimate the Station noise contribution at the other nearby NSAs that are more distant than the closest NSA.

\*Attenuation due to hemispherical sound propagation: Sound propagates outwards in all directions (i.e., length, width, height) from a point source, and the sound energy of a noise source decreases with increasing distance from the source. In the case of hemispherical sound propagation, the source is located on a flat continuous plane/surface (e.g., ground), and the sound radiates hemispherically (i.e., outward, over and above the surface) from the sound source. The following equation is the theoretical decrease of sound energy when determining the resulting SPL values of a noise source at a specific distance ("r") of a receiver from the estimated PWL values:

Decrease in SPL ("hemispherical propagation") from a noise source =  $20 \cdot \log(r) - 2.3 \text{ dB}$   
where "r" is distance of the receiver from the noise source.

\*\*Attenuation due to air absorption: Air absorbs sound energy, and the amount of absorption ("attenuation") is dependent on the temperature and relative humidity (R.H.) of air and frequency of sound. For example, the attenuation due to air absorption for 1000 Hz O.B. SPL is approximately 1.5 dB per 1,000 feet for standard day conditions (i.e., no wind, 60 deg. F. and 70% or 50% R.H.).

The estimated unweighted O.B. PWLs of the motor-driven pumps, piping, substation equipment and any other site equipment were estimated from field sound measurements by H&K on similar equipment or from sound data provided by the equipment manufacturer.

**APPENDIX: Summary of Acoustical Terminology, Typical Metrics for Regulating Environmental Noise and Sound Levels for Typical Activities**

- (1) **Decibel (dB):** A unit for expressing the relative power level difference between acoustical or electrical signals. It is ten times the common logarithm of the ratio of two related quantities that are proportional to power. When adding dB or dBA values, the values must be added logarithmically. For example, the logarithmic addition of **35 dB** plus **35 dB** is **38 dB**.
- (2) **A-Weighted Sound Level (dBA):** The A-wt. sound level is a single-figure sound rating, expressed in decibels (Re 20  $\mu$ Pa), which correlates to the human perception of the loudness of sound. The dBA level is commonly used to measure industrial and environmental noise since it is easy to measure and provides a reasonable indication of the human annoyance value of the noise. The dBA measurement is not a good descriptor of a noise consisting of strong low-frequency components or for a noise with tonal components.

The A-weighted curve approximates the response of the average ear at sound levels of 20 to 50 decibels. The following are the relative response of A-weighted filter per octave band frequency, and a graph/curve is provided that shows a graphical representation of the A-wt. filter response per frequency (in Hz).

31.5 Hz	63 Hz	125 Hz	250 Hz	500 Hz	1,000 Hz	2,000 Hz	4,000 Hz	8,000 Hz	16,000 Hz
-39.4 dB	-26.2 dB	-16.1 dB	-8.6 dB	-3.2 dB	0 dB	+1.2 dB	+1.0 dB	-1.1 dB	-6.6 dB

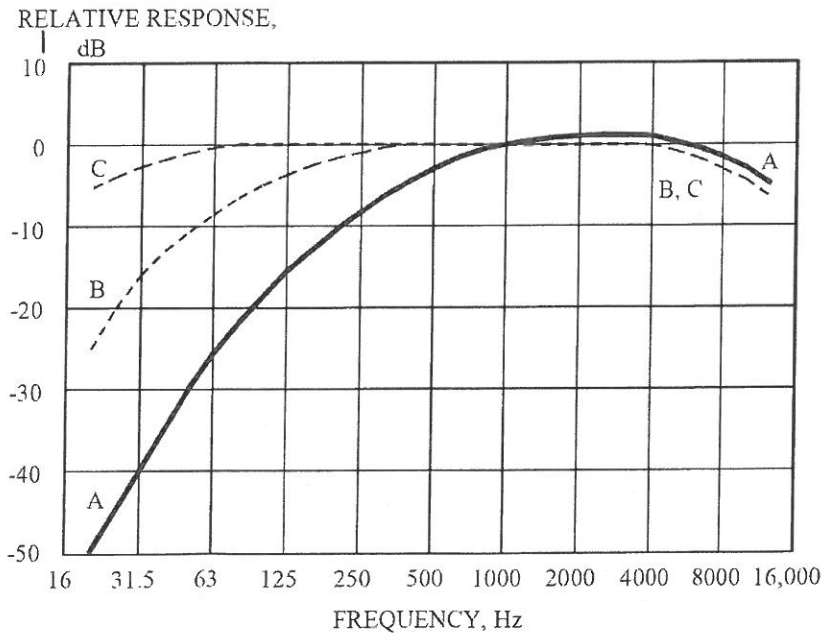



- (3) Human Perception of Change in Sound Level
- A **3 dB** change of sound level is barely perceivable by the human ear
  - A **5 or 6 dB** change of sound level is noticeable
  - If sound level increases by **10 dB**, it appears as if the sound intensity has doubled.
- (4) Background or Ambient Noise: The total noise produced by all other sources associated with a given environment in the vicinity of a specific source of interest, and includes any Residual Noise.
- (5) Sound Pressure Level ( $L_p$  or SPL): Ten times the common logarithm to the base 10 of the ratio of the mean square sound pressure to the square of a reference pressure. Therefore, the sound pressure level is equal to 20 times the common logarithm of the ratio of the sound pressure to a reference pressure (20 micropascals or 0.0002 microbar).
- (6) Octave Band SPL: Sound is typically measured in frequency ranges (e.g., high-pitched sound, low-pitched sound, etc.) that provides more meaningful sound data regarding the sound character of the noise. When measuring two noise sources for comparison, it is better to measure the spectrum of each noise, such as in octave band SPL frequency ranges. Then, the relative loudness of two sounds can be compared frequency range by frequency range. As an illustration, two noise sources can have the same dBA rating and yet sound completely different. For example, a high-pitched sound concentrated at a frequency of 2000 Hz could have the same dBA rating as a much louder low-frequency sound concentrated at 50 Hz.
- (7) Daytime Sound Level ( $L_d$ ) & Nighttime Sound Level ( $L_n$ ):  $L_d$  is the equivalent A-weighted sound level, in decibels, for a 15 hour time period, between 07:00 to 22:00 Hours (7:00 a.m. to 10:00 p.m.).  $L_n$  is the equivalent A-weighted sound level, in decibels, for a 9 hour time period, between 22:00 to 07:00 Hours (10:00 p.m. to 7:00 a.m.).
- (8) Equivalent Sound Level ( $L_{eq}$ ): The equivalent sound level ( $L_{eq}$ ) can be considered an average sound level measured during a period of time, including any fluctuating sound levels during that period. In this report, the  $L_{eq}$  is equal to the level of a steady (in time) A-weighted sound level that would be equivalent to the sampled A-weighted sound level on an energy basis for a specified measurement interval. The concept of the measuring  $L_{eq}$  has been used broadly to relate individual and community reaction to aircraft and other environmental noises.
- (9) L-Percent Sound Levels: The L percent levels (e.g.,  $L_{50}$ ,  $L_{90}$  &  $L_{10}$ ) refer to the A-wt. sound levels that are exceeded for 90, 50 and 10 percent of the time, respectively, during a measurement period. For example, the 90-percentile exceeded sound level, designated to as  $L_{90}$ , is the A-wt. sound levels that are exceeded for 90 percent of the time and is considered the typical lowest anticipated sound levels. The range between the  $L_{10}$  and  $L_{90}$  values usually provides a good indication of the variability of the sound levels during the period of measurement.

- (10) Sound Level Meter (SLM): An instrument used to measure sound pressure level, sound level, octave-band SPL, or peak sound pressure level, separately or in any combinations thereof. The measured weighted SPL (i.e., A-Wt. Sound Level or dBA) is obtained by the use of a SLM having a standard frequency-filter for attenuating part of the sound spectrum.
- (11) Sound Power Level ( $L_w$  or PWL): Ten times the common logarithm of the ratio of the total acoustic power radiated by a sound source to a reference power. A reference power of a picowatt or  $10^{-12}$  watt is conventionally used.
- (12) Tone: A tone is a sound sensation-having pitch, which is a listener's perception of the frequency (for example, the higher the frequency, the higher the pitch). For a measured sound spectrum, a tone is represented as a "peak" in the spectrum curve. Noise that contains significant tones is considered a tonal type of noise.
- (13) List of Common Environmental (i.e., Man-Made & Natural) Noise Sources: For reference, the following **Table** presents a list of some common environmental (i.e., man-made and natural) noise sources as compared to the estimated sound level of the pumping station at the closest NSAs. Note that inside a typical house, the noise level of an outdoor noise source is approximately **15 to 20 dB** quieter (i.e., house typically provides at least **15 to 20 dB** noise reduction).

Type of Noise Source	Approx. A-Wt. Sound Level	Approximate Distance To Noise Source
Lawn mower (outdoor)	50 – 55 dBA	150 to 200 feet
Passenger cars @ 50 – 60 mph (outdoor)	50 – 55 dBA	250 to 300 feet
Residential AC unit (outdoor)	50 – 60 dBA	40 to 50 feet
Residential AC unit (outdoor)	35 – 45 dBA	200 to 250 feet
Chemical plant (outdoor)	40 – 50 dBA	½ mile from plant
Cicadas (outdoor, summertime @ night)	50 – 55 dBA	General area of insects
Window AC unit (indoor)	50 – 60 dBA	5 to 20 feet
TV @ normal listening level (indoor)	60 – 70 dBA	10 to 15 feet
Vacuum cleaner (indoor)	70 – 75 dBA	10 to 15 feet
NSA #1 (closest residence to the Station)	32.6 dBA	Approx. 1,000 feet
NSA #2 (next closest residence to the Station)	23.2 dBA	Approx. 2,600 feet

List of Some Common Environmental Noise Sources compared to Station Sound Level at Closest NSAs

SOUND LEVELS FOR TYPICAL ACTIVITIES			REFERENCE AND COMMUNITY RESPONSES		
Subjective Human Response and Conversation	Home and Industrial (Indoor Noise)	dBA Scale (Level)	Community and Traffic (Outdoor Noise)	Reference Loudness	Community Reaction To Outdoor Noise
Threshold of Pain		-- 140 --	Aircraft Carrier Military Jet Aircraft		
		-- 130 --			
Threshold of Discomfort	Rock Band (Max.)	-- 120 --	Large Siren at 100 Ft. Jet Takeoff at 200 Ft.	16 Times as Loud	
	Discotheque (Max.)	-- 110 --	Thunderstorm Activity Elevated Train	8 Times as Loud	
Maximum Vocal Effort	Symphonic Music (Max.)	-- 110 --			
Very Loud	Industrial Plant	-- 100 --	Auto Horn at 5 Ft.	4 Times as Loud	
	Newspaper Printing Rm.		Compacting Trash Truck	2 Times as Loud	
Shouting in Ear	Food Blender Symphonic Music (Typ.)	-- 90 --	Heavy Truck at 25 Ft.	Reference Loudness	Vigorous Action and Law Suits
Shouting	Garbage Disposal	-- 80 --	Motorcycle at 25 Ft.		Threats of Legal Action
	Alarm Clock	-- 70 --	Small Truck at 25 Ft. Heavy Traffic at 50 Ft.	1/2 as Loud	Appeals to Officials
Moderately Loud	Vacuum Cleaner		Avg. Traffic at 100 Ft.		Widespread Complaints
	Electric Typewriter	-- 60 --		1/4 as Loud	
Normal Conversation	Air Conditioner at 20 Ft.				Sporadic Complaints
	Typical Office	-- 50 --	Light Traffic at 100 Ft.	1/8 as Loud	No Reaction, Although Noise is Noticeable
Quiet	Living Room		Typical Suburban Area		
	Bedroom	-- 40 --			
Very Quiet	Library	-- 30 --	Birdsong		
	Soft Whisper	Broadcasting Studio			
			Rural Area	Just Audible	
		-- 20 --			
		-- 10 --		Threshold of Hearing	
Hoover & Keith Inc. (Consultants in Acoustics) 11231 Meacham Ln. Suite D Houston, Texas 77052		-- 0 --			

**MACON COUNTY BOARD RESOLUTION  
APPOINTMENT TO THE  
DECATUR-MACON COUNTY  
OPPORTUNITIES CORPORATION  
(DMCOC)**

**RESOLUTION NO. G-4021-1-14**

**WHEREAS**, it is the desire of the County Board Chairman to appoint the below individual to the Board of Directors of the Decatur-Macon County Opportunities Corporation (DMCOC) filling existing term of Lois Durbin:

Antonio D. Brown  
333 S. Franklin St.  
Decatur, Illinois 62523  
Terms Expire: November 30, 2014

**NOW, THEREFORE, BE IT RESOLVED** by the Macon County Board that it hereby appoints ANTONIO D. BROWN to the Decatur-Macon County Opportunities Corporation (DMCOC) filling an existing term set to expire the 30<sup>th</sup> of November, 2014.

**BE IT FURTHER RESOLVED** that this Resolution shall become effective immediately upon the adoption thereof.

**PRESENTED, PASSED and APPROVED** this 9<sup>th</sup> day of January, 2014.

AYES \_\_\_\_\_ NAYS \_\_\_\_\_

MACON COUNTY BOARD  
MACON COUNTY, ILLINOIS

ATTEST:

BY:

\_\_\_\_\_  
Stephen M. Bean, Clerk for the  
County of Macon, State of Illinois

\_\_\_\_\_  
Jay A. Dunn, Chairman  
Macon County Board

**MACON COUNTY BOARD RESOLUTION  
APPOINTMENT TO THE MACON COUNTY  
REGIONAL PLANNING COMMISSION**

*Patrick Murphy*

**RESOLUTION NO. G-4022-1-14**

**WHEREAS**, it is the desire of the Macon County Board Chairman to appoint the following individual to the Macon County Regional Planning Commission for a 3 year term set to expire 12-31-2016:

Patrick Murphy  
9 Allen Bend  
Decatur, IL62521  
Term Expires: 12-31-2016

**NOW, THEREFORE, BE IT RESOLVED** by the Macon County Board that it hereby approves the appointment of Patrick Murphy for the Macon County Regional Planning Commission for a 3 year term set to expire 12-31-2016.

**BE IT FURTHER RESOLVED** that this Resolution shall become effective immediately upon the adoption thereof.

**PRESENTED, PASSED and APPROVED** this 9<sup>th</sup> day of January, 2014.

AYES \_\_\_\_\_ NAYS \_\_\_\_\_

MACON COUNTY BOARD  
MACON COUNTY, ILLINOIS

ATTEST:

BY:

\_\_\_\_\_  
Stephen M. Bean, Clerk for the  
County of Macon, State of Illinois

\_\_\_\_\_  
Jay A. Dunn, Chairman  
Macon County Board

**MACON COUNTY BOARD RESOLUTION  
TO EXECUTE DEEDS TO CONVEY PROPERTY  
ON WHICH TAXES WERE DELINQUENT**

**RESOLUTION NO. G-4023-1-14**

**WHEREAS**, the County of Macon has undertaken a program to collect delinquent taxes and to perfect titles to real property in cases where the taxes on same have not been paid pursuant to 35 ILCS 200/21-90; and

**WHEREAS**, pursuant to this program the County of Macon, as Trustee for the taxing districts involved, has acquired an interest in the real estate described in the attachment to this resolution; and

**WHEREAS**, it appears to the Macon County Board that it would be to the best interest of the taxing districts of Macon County to dispose of this interest in said property.

**NOW, THEREFORE, BE IT RESOLVED** by the Macon County Board that the Chairman of the Macon County Board is hereby authorized to execute a deed of conveyance of the county's interest, authorization, or the cancellation of the appropriate certificate of purchase as the case may be on the following real estate for the sums shown on the attachment and to be disbursed as shown and according to law.

**BE IT FURTHER RESOLVED** by the Macon County Board that this resolution shall become effective upon the adoption thereof.

**PRESENTED, PASSED, APPROVED** 9<sup>th</sup> day of January , 2013

AYES \_\_\_\_\_ NAYS \_\_\_\_\_

MACON COUNTY BOARD  
MACON COUNTY, ILLINOIS

ATTEST:

BY:

\_\_\_\_\_  
Stephen M. Bean, Clerk for the  
County of Macon, State of Illinois

\_\_\_\_\_  
Jay A. Dunn, Chairman  
Macon County Board

RES#	Account	Type	Account Name	Total Collected	County Clerk	Auctioneer	Recorder/ Sec of State	Agent	Treasurer
01-14-001	0913024F	SAL	DALE FOSTER	6,605.00	0.00	65.00	40.00	1,625.00	4,875.00
01-14-002	0913026F	SAL	TRAVIS L YANCY	646.00	0.00	6.00	40.00	350.00	250.00
01-14-003	0913293F	SAL	LOUIS BINKLEY	1,252.00	0.00	12.00	40.00	350.00	850.00
01-14-004	0913339F	SAL	STEVEN D COX	7,413.00	0.00	73.00	40.00	1,825.00	5,475.00
01-14-005	200800270	DEF-REC	PHIL TAYLOR	1,251.00	0.00	0.00	0.00	492.41	758.59
Totals				\$17,167.00	\$0.00	\$156.00	\$160.00	\$4,642.41	\$12,208.59

*[Handwritten Signature]*  
 \_\_\_\_\_  
*[Handwritten Signature]*  
 \_\_\_\_\_  
*Mama Gorman*      *Patty Cox*  
 \_\_\_\_\_                      \_\_\_\_\_  
*Joy A. Diner*                      *[Handwritten Signature]*  
 \_\_\_\_\_                      \_\_\_\_\_  
 Committee Members

Clerk Fees                      \$0.00  
 Recorder/Sec of State Fees                      \$160.00  
 Total to County                      \$12,368.59

12/17/2013

**Macon County January 2014  
Monthly Resolution List with Descriptions**

Page 1 of 1

RES#	Account	Type	Account Name	Description
01-14-001	0913024F	SAL	DALE FOSTER	1502 W. GRAND AVE. DECATUR, IL 1.5 STORY FRAME
01-14-002	0913026F	SAL	TRAVIS L YANCY	1800 W. PACKARD ST. DECATUR, IL VACANT LOT PARTIALLY FENCED
01-14-003	0913293F	SAL	LOUIS BINKLEY	1530 N. JASPER ST. DECATUR, IL 1 STORY FRAME
01-14-004	0913339F	SAL	STEVEN D COX	1735 N. 23RD ST. DECATUR, IL 1 STORY FRAME
01-14-005	200800270	DEF-REC	PHIL TAYLOR	1065 N. COLLEGE ST. DECATUR 62522



**MACON COUNTY BOARD RESOLUTION  
APPROVING INCREASE IN APPROPRIATIONS  
IN THE PROBATION GRANT FUND FOR JUVENILE REDEPLOY ILLINOIS  
GRANT**

**RESOLUTION NO. G-4024-1-14**

**WHEREAS**, the Probation Department received a SFY14 grant termed the “Juvenile Redeploy” Grant (FCSSR03210) from the Illinois Department of Human Services; and

**WHEREAS**, the Illinois Department of Human Services awarded Macon County \$321,650 in funding to Macon County for the 2014 SFY beginning July 1, 2013, and

**WHEREAS**, the State and Federal Fiscal Years do not completely coincide with the County Fiscal Year, thereby creating a timing issue concerning the recording of revenue and expenditures for said grants, and

**WHEREAS**, as is usual this time of year significant work including forecasting is required to bring Macon County budgets and actuals into alignment within the contracts for multiyear grants,

**WHEREAS**, an amendment to the budget of the Probation Grant fund for the Juvenile Redeploy Grant has become necessary to record the modified revenue and expenditures authorized by the grantor in granting this revenue to Macon County, and

**WHEREAS**, unforeseen circumstances have arisen which give rise to an emergency situation in that valuable grant funds will be lost and employees will not get paid without the amending of these budgets; and

**WHEREAS**, the proposed budget amendments were discussed by the Macon County Justice Committee on December 19, 2013 and recommended for approval to the Macon County Finance Committee, and

**WHEREAS**, the proposed budget amendments were discussed by the Macon County Finance Committee on December 30, 2013 and recommended for approval by the full Board, and

**WHEREAS**, the Finance Committee has agreed to the amending of the Probation Grant Juvenile Redeploy budget as follows,

Additional Revenue		
A095-056-4330	grant revenue	\$20,350.00
Additional Expenditure		
A095-056-7200	Contractual	\$20,350.00

**NOW, THEREFORE, BE IT RESOLVED** by the Macon County Board that it hereby approves the amendment of the Probation Grant budget as above.

**BE IT FURTHER RESOLVED BY THE** Macon County Board that this Resolution shall become effective upon the adoption thereof.

**PRESENTED, PASSED, and APPROVED** this 9th day of January, 2014.

AYES \_\_\_\_\_ NAYS \_\_\_\_\_

MACON COUNTY BOARD  
MACON COUNTY, ILLINOIS

ATTEST:

BY:

\_\_\_\_\_  
Stephen M. Bean, Clerk for the  
County of Macon, State of Illinois

\_\_\_\_\_  
Jay A. Dunn, Chairman  
Macon County Board

**MACON COUNTY BOARD RESOLUTION  
APPROVING INCREASE IN APPROPRIATIONS IN THE  
CIRCUIT COURT'S FY14 BUDGET FOR EXPENSES FEES IN CERTAIN APPEALS**

**RESOLUTION NO. G-4025-1-14**

**WHEREAS**, petitions have been brought seeking to declare defendants to be sexually dangerous persons (SDP); and

**WHEREAS**, state law requires that expenses incurred for psychological examinations of defendants in SDP cases are to be paid from a county's general fund; and

**WHEREAS**, such expenses in the amount of \$2,640.00 have been incurred in Macon County case no. 12-CF-1491; \$2,665.00 and \$573.75 in Macon County case nos. 12-CF-1287 and 13-CF-380; and

**WHEREAS**, by prior consensus of this Board, appropriations for expenses involving SDP cases would be made on an ad hoc basis; and

**WHEREAS**, an appropriation for \$5,878.75 is necessary and proper; and

**WHEREAS**, the above appropriation was approved by the Justice Committee on December 19, 2013 and the Finance Committee on December 30, 2013.

**NOW, THEREFORE**, be it resolved by the Macon County Board that the Circuit Court's appropriation for certain appeals (001-140-7390) be increased by the sum of \$5,878.75.

**BE IT FURTHER RESOLVED** this resolution shall become effective upon the adoption thereof.

**PRESENTED, PASSED AND APPROVED** this 9th day of January, 2014.

AYES \_\_\_\_\_ NAYS \_\_\_\_\_

MACON COUNTY BOARD  
MACON COUNTY, ILLINOIS

ATTEST:

BY:

---

Stephen M. Bean, Clerk for the  
County of Macon, State of Illinois

---

Jay A. Dunn, Chairman  
Macon County Board

MACON COUNTY BOARD RESOLUTION ACCEPTING  
A ONE YEAR PROPOSAL FROM A J GALLAGHER  
FOR PROPERTY AND INLAND MARINE INSURANCE COVERAGE

RESOLUTION NO. G-4026-1-14

WHEREAS, Macon County purchases commercial insurance for losses connected with property and inland marine scheduled equipment; and

WHEREAS, Macon county has purchased this coverage from the Hartford Company for several years ;  
and

WHEREAS, Macon County went to market for an open bid on this coverage this year with the results as contained in the attachment, and

WHEREAS, United Fire & Casualty provided the best quotation for these lines of coverage as further detailed in the attachment, and

WHEREAS, the Operations & Personnel Committee (OP) discussed this quote on 12-16-2013 and agreed to negotiate with United Fire for coverage including full replacement cost of all buildings, and whereas the revised proposal including the full replacement cost of all buildings was discussed by the Finance Committee on December 30, 2013 and

WHEREAS, this proposal is for the named insurance from 2-1-2014 to 1-31-2015.

NOW, THEREFORE BE IT RESOLVED by the Macon County Board that it hereby approves accepting the attached proposal from A J Gallagher.

BE IT FURTHER RESOLVED that this resolution shall become effective upon the adoption thereof.

**PRESENTED, PASSED, APPROVED** this 9<sup>th</sup> day of January, 2014

AYES \_\_\_\_\_ NAYS \_\_\_\_\_

MACON COUNTY BOARD

MACON COUNTY, ILLINOIS

ATTEST:

BY:

\_\_\_\_\_

\_\_\_\_\_

Stephen M. Bean, Clerk for the  
County of Macon, State of Illinois

Jay A. Dunn, Chairman  
Macon County Board



# Arthur J. Gallagher & Co.

December 19, 2013

Amy Stockwell  
County of Macon  
141 South Main Street  
Suite 312  
Decatur, IL 62523-1274

Re: 2014 – 2015 Property & Inland Marine Renewal  
February 1, 2014 to February 1, 2015

Dear Amy:

Your Property and Inland Marine policies will be renewing shortly. Attached is our quotation for coverage.

We are not aware of any changes in your exposures to loss, nor are we aware of any changes in your business operations that would necessitate additional coverage options. Please notify us immediately if you are planning any new business operations.

We would like to outline the following notable points for your consideration:

- Any entity not named above, may not be an insured entity. This may include partnerships and joint ventures.
- The insurance carrier is United Fire & Casualty Company.
- The A. M. Best rating is A X. The A. M. Best Rating Summary is attached for your review.
- The renewal premium is \$24,066.
- The premium is not subject to annual audit.
- Defense costs are limited and included within the policy limits.
- Significant policy exclusions include but are not limited to the following:
  - Exclusion of Loss due to Virus/Bacteria
  - Water Exclusion Endorsement
- Include a Statement of Values or schedule of values by location.
- The values and schedules are per the expiring policy. It is your responsibility to notify us of all necessary changes to your schedules.
- Claims Handling Instructions by Policy –Immediately contact United Fire & Casualty Company by phone at 800-343-9131.
- Gallagher is responsible for the placement of the following lines of coverage:
  - Commercial Package
  - Commercial Automobile
  - Crime
  - Umbrella & Excess Liability
  - Cyber Liability
  - Workers Compensation

It is understood that any other type of exposure/coverage is either self-insured or placed by another brokerage firm other than Gallagher. If you need help in placing other lines of coverage or covering other types of exposures, please contact your Gallagher representative.

- It is recommended that you consider purchasing coverage for the following, which are not included in your insurance program. Pollution Liability, Professional Liability, Foreign Liability, Flood, and Increased building reconstruction costs due to enforcement of local building laws.
- **To bind this policy**, please refer to the "Client Authorization to Bind Coverage" page attached.
  1. Note any changes you desire to be made.
  2. Date and sign.
  3. Return prior to the effective date of coverage.

We appreciate your business and look forward to working with you in the coming year. Please contact me if you have any questions.

Sincerely,

A handwritten signature in cursive script that reads "T. M. Miller".

Ted Miller

Enclosure

## COMPENSATION DISCLOSURE SCHEDULE

Coverage(s)	Carrier Name(s)	Wholesaler, MGA, or Intermediary Name 1	Estimated Annual Premium 2	Comm % or Fee 3	Wholesaler, MGA or Intermediary % 4	AJG Owned? Yes or No
Property & IM	United Fire & Casualty Company	N/A	\$24,066	15%	N/A	N/A
Property & IM	Hartford Insurance Company of Illinois	N/A	\$30,703	15%	N/A	N/A
Property & IM	Great American	N/A	\$25,242	20%	N/A	N/A
Property & IM	Harleysville	N/A	\$47,288	20%	N/A	N/A

Some carriers pay Gallagher supplemental or contingent commissions in addition to the policy commission. Contingent commissions are typically contingent upon performance factors such as growth, profit, volume or retention, while supplemental commissions are not. These supplemental or contingent commissions may range from less than 1% up to 10 % of the policy premium. Please refer to the Contingent and Supplemental Commission Disclosure or contact your Gallagher representative for additional information.

1. We were able to obtain more advantageous terms and conditions for you through an intermediary/ wholesaler.
2. If the premium is shown as an indication: The premium indicated is an estimate provided by the market. The actual premium and acceptance of the coverage requested will be determined by the market after a thorough review of the completed application.  
\* A verbal quotation was received from this carrier. We are awaiting a quotation in writing.
3. The commission rate is a percentage of annual premium excluding taxes & fees.  
\* Gallagher is receiving \_\_\_% commission on this policy. The fee due Gallagher will be reduced by the amount of the commissions received.
4. \* The non-Gallagher intermediary/wholesaler did not provide their compensation information for this proposal. The usual and customary compensation to a wholesaler/ intermediary ranges from 5% to 12%, but we cannot verify that range is applicable in connection with this proposal.

## IMPORTANT DISCLOSURES

The quotations(s) attached are an outline of certain terms and conditions of the insurance proposed by the insurers, based on the information provided by your company. It does not include all the terms, coverages, exclusions, limitations and/or conditions of the actual policy contract language. The insurance policies themselves must be read for those details. Policy forms for your reference will be made available upon request.

We will not be operating in a fiduciary capacity, but only as your broker, obtaining a variety of coverage terms and conditions to protect the risks of your enterprise. We will seek to bind those coverages based upon your authorization; however, we can make no warranties in respect to policy limits or coverage considerations of the carrier. Actual coverage is determined by policy language, so read all policies carefully. Contact us with questions on these or any other issues of concern.

The information contained in this proposal is based on the historical loss experience and exposures provided to Arthur J. Gallagher Risk Management Services, Inc. This proposal is not an actuarial study. Should you wish to have this proposal reviewed by an independent actuary, we will be pleased to provide you with a listing of actuaries for your use.

If this proposal contains options to purchase TRIA/TRIPRA coverage, the proposed TRIA/TRIPRA program may not cover all terrorism losses. While the most recent legislation eliminated the distinction between foreign and domestic acts of terrorism, a number of lines of coverage excluded under the TRIEA legislation passed in 2005 remain excluded, including commercial automobile, burglary and theft insurance; surety insurance, farmowners multiple perils and professional liability (although directors and officers liability is specifically included). If such excluded coverages are required, we recommend that you consider purchasing a separate terrorism policy. Please note that a separate terrorism policy for these excluded coverages may be necessary to satisfy loan covenants or other contractual obligations.

## COMPENSATION DISCLOSURES

One of the core values highlighted in The Gallagher Way states, "We are an Open Society," and our open society extends to the compensation Gallagher receives. For more information on Gallagher's compensation arrangements, please visit <http://www.ajg.com/compdisclosure>. In general, Gallagher may be compensated as follows:

1. Gallagher Companies are primarily compensated from the usual and customary commissions or fees received from the brokerage and servicing of insurance policies, annuity contracts, guarantee contracts and surety bonds (collectively "insurance coverages") handled for a client's account, which such commissions and fees may vary from company to company and insurance coverage to insurance coverage. As permitted by law, Gallagher companies occasionally receive both commissions and fees. In placing, renewing, consulting on or servicing your insurance coverages, Gallagher Companies may participate in contingent commission arrangements with intermediaries and insurance companies that provide for additional contingent compensation if underwriting, profitability, volume or retention goals are achieved. Such goals are typically based on the total amount of certain insurance coverages placed by Gallagher with the insurance company and/or through the intermediary, not on an individual policy basis. As a result, Gallagher may be considered to have an incentive to place your insurance coverages with a particular insurance company.
2. Gallagher Companies may also receive investment income on fiduciary funds temporarily held by them, such as premiums or return premiums.
3. Gallagher Companies may access other facilities, including wholesalers, reinsurance intermediaries, captive managers, underwriting managers and others that act as intermediaries for both Gallagher and other brokers in the insurance marketplace. Gallagher Companies may own some of these facilities, in whole or in part. If such a facility was utilized in the placement of a client's account, the facility may have earned and retained customary brokerage commission or fees for its work.
4. Gallagher assists its customers in procuring premium finance quotes and unless prohibited by law may earn compensation for this value added service.

If you have specific questions about the compensation received by Gallagher and its affiliates in relation to your insurance placements, please contact your Gallagher representative for more details.

In the event you wish to register a formal complaint regarding compensation Gallagher receives from insurers or third parties, please send an e-mail to [Compensation\\_Complaints@ajg.com](mailto:Compensation_Complaints@ajg.com) or send a letter to:

AVC Compliance Officer  
Arthur J. Gallagher & Co.  
Two Pierce Place, 20<sup>th</sup> Floor  
Itasca, IL 60143





## COMMERCIAL ACCOUNTS CONTINGENT AND SUPPLEMENTAL COMMISSION DISCLOSURE

---

Effective October 1, 2009, Arthur J. Gallagher & Co., and its subsidiaries operating as insurance agents/brokers under the corporate holding company known as Arthur J. Gallagher Brokerage & Risk Management Services, LLC, resumed participating in contingent commission arrangements which are routinely offered by insurance companies and intermediaries to agents and brokers, after voluntarily foregoing the benefit of this type of compensation since January 1, 2005. Contingent commission arrangements provide for additional compensation if certain underwriting, profitability, volume or retention goals are achieved. Such goals are typically based on the total amount of certain insurance coverages placed by Gallagher with the insurance company and/or through the intermediary, not on an individual policy basis. As a result, Gallagher may be considered to have an incentive to place your insurance coverages with a particular insurance company.

During the time Gallagher's retail operations did not accept contingent commissions, some insurance markets and intermediaries, including Gallagher owned intermediaries, modified their commission schedule with Gallagher, resulting in an increase in some commission rates. The additional commissions, commonly referred to as "supplemental commissions", are known at the effective date of the policy, but some intermediaries and insurance companies are paying the commission increase apart and later from when the commission is normally paid at policy issuance.

Unlike contingent commissions, supplemental commission payments are determined without regard to any performance factors which are contingent on future growth, retention, profitability, etc.

Contingent and supplemental commission ranges from less than 1% up to 10% of written or earned premium on eligible lines of business (not all lines of business qualify).

**NOTE:** Upon request, your Gallagher representative can provide more specific market information regarding contingent and supplemental commission related to your insurance coverage.

## Carrier Ratings and Admitted Status

Proposed Carrier	A. M. Best's Rating	Admitted/Non-Admitted
United Fire & Casualty Company	A X	Admitted
Hartford Insurance Company of Illinois	A XV	Admitted
Great American Insurance Company	A XIV	Admitted
Harleysville Lake States Ins Co	A+ XV	Admitted

If the above indicates coverage is placed with a non-admitted carrier, the carrier is doing business in the state as a surplus lines or non-admitted carrier. As such, this carrier is not subject to the same regulations which apply to an admitted carrier nor do they participate in any insurance guarantee fund applicable in that state.

The above A.M. Best Rating was verified on the date the proposal document was created.

### Guide to Best Ratings Rating Levels and Categories

Level	Category	Level	Category	Level	Category
A++, A+	..... Superior	B, B-	.....Fair	D.....	.....Poor
A, A-	..... Excellent	C++, C+	.....Marginal	E.....	Under Regulatory Supervision
B++, B+	..... Good	C, C-	..... Weak	F.....	In Liquidation
				S.....	Suspended

### Financial Size Categories

*(In \$000 of Reported Policyholders' Surplus Plus Conditional Reserve Funds)*

FSC I	Up to	1,000	FSC IX	250,000	to	500,000	
FSC II	1,000	to	2,000	FSC X	500,000	to	750,000
FSC III	2,000	to	5,000	FSC XI	750,000	to	1,000,000
FSC IV	5,000	to	10,000	FSC XII	1,000,000	to	1,250,000
FSC V	10,000	to	25,000	FSC XIII	1,250,000	to	1,500,000
FSC VI	25,000	to	50,000	FSC XIV	1,500,000	to	2,000,000
FSC VII	50,000	to	100,000	FSC XV	2,000,000	or more	
FSC VIII	100,000	to	250,000				

Best's Insurance Reports, published annually by A.M. Best Company, Inc., presents comprehensive reports on the financial position, history, and transactions of insurance companies operating in the United States and Canada. Companies licensed to do business in the United States are assigned a Best's Rating which attempts to measure the comparative position of the company or association against industry averages.

A Best's Financial Strength Rating opinion addresses the relative ability of an insurer to meet its ongoing insurance obligations. It is not a warranty of a company's financial strength and ability to meet its obligations to policyholders. View the A.M. Best Important Notice: Best's Credit Ratings for a disclaimer notice and complete details at <http://www.ambest.com/ratings/notice>.

Best's Credit Ratings are under continuous review and subject to change and/or affirmation. For the latest Best's Credit Ratings and Best Credit Reports (which include Best Ratings), visit the A.M. Best website at <http://www.ambest.com>. See Guide to Best's Credit Ratings for explanation of use and charges. Copies of the Best's Insurance Reports for carriers listed above are also available upon request of your Gallagher representative.

Best's Credit Ratings reproduced herein appear under license from A.M. Best and do not constitute, either expressly or impliedly, an endorsement of (Licensee's publication or service) or its recommendations, formulas, criteria or comparisons to any other ratings, rating scales or rating organizations which are published or referenced herein. A.M. Best is not responsible for transcription errors made in presenting Best's Credit Ratings. Best's Credit Ratings are proprietary and may not be reproduced or distributed without the express written permission of A.M. Best Company.

Gallagher companies use A.M. Best Company's rating services to evaluate the financial condition of insurers whose policies we propose to deliver. Gallagher companies make no representations and warranties concerning the solvency of any carrier, nor does it make any representation or warranty concerning the rating of the carrier which may change.

## GUIDE TO BEST'S FINANCIAL STRENGTH RATINGS – INSURER

A Best's Financial Strength Rating is an independent opinion of an insurer's financial strength and ability to meet its ongoing insurance policy and contract obligations. The rating is based on a comprehensive quantitative and qualitative evaluation of a company's balance sheet strength, operating performance and business profile.

### Financial Strength Ratings – Insurer

	Rating	Descriptor	Definition
Secure	A++, A+	Superior	Assigned to companies that have, in our opinion, a superior ability to meet their ongoing insurance obligations.
	A, A-	Excellent	Assigned to companies that have, in our opinion, an excellent ability to meet their ongoing insurance obligations.
	B++, B+	Good	Assigned to companies that have, in our opinion, a good ability to meet their ongoing insurance obligations.
Vulnerable	B, B-	Fair	Assigned to companies that have, in our opinion, a fair ability to meet their ongoing insurance obligations. Financial strength is vulnerable to adverse changes in underwriting and economic conditions.
	C++, C+	Marginal	Assigned to companies that have, in our opinion, a marginal ability to meet their ongoing insurance obligations. Financial strength is vulnerable to adverse changes in underwriting and economic conditions.
	C, C-	Weak	Assigned to companies that have, in our opinion, a weak ability to meet their ongoing insurance obligations. Financial strength is very vulnerable to adverse changes in underwriting and economic conditions.
	D	Poor	Assigned to companies that have, in our opinion, a poor ability to meet their ongoing insurance obligations. Financial strength is extremely vulnerable to adverse changes in underwriting and economic conditions.
	E	Under Regulatory Supervision	Assigned to companies (and possibly their subsidiaries/affiliates) placed under a significant form of regulatory supervision, control or restraint - including cease and desist orders, conservatorship or rehabilitation, but not liquidation - that prevents conduct of normal, ongoing insurance operations.
	F	In Liquidation	Assigned to companies placed in liquidation by a court of law or by a forced liquidation.
	S	Suspended	Assigned to rated companies when sudden and significant events affect their balance sheet strength or operating performance and rating implications cannot be evaluated due to a lack of timely or adequate information.

### Rating Outlooks

Assigned to an interactive Financial Strength Rating to indicate its potential direction over an intermediate term, generally defined as 12 to 36 months.

**Positive** Indicates possible rating upgrade due to favorable financial/market trends relative to the current rating level.

**Negative** Indicates possible rating downgrade due to unfavorable financial/market trends relative to the current rating level.

**Stable** Indicates low likelihood of a rating change due to stable financial/market trends.

### Rating Modifiers

Modifier	Descriptor	Definition
u	Under Review	Indicates the rating may change in the near term, typically within six months. Generally is event driven, with positive, negative or developing implications.
pd	Public Data	Indicates rating assigned to insurer that chose not to participate in A.M. Best's interactive rating process.
s	Syndicate	Indicates rating assigned to a Lloyd's syndicate.

### Affiliation Codes

Indicates rating is based on a type of affiliation with other insurers.      g      Group      p      Pooled      r      Reinsured

### Not Rated Categories

Assigned to companies reported on by A.M. Best, but not assigned a Best's Rating.

NR-1: Insufficient Data.      NR-2: Insufficient Size and/or Operating Experience.      NR-3: Rating Procedure Inapplicable.

NR-4: Company Request.      NR-5: Not Formally Followed.

### Rating Disclosure

A Best's Financial Strength Rating opinion addresses the relative ability of an insurer to meet its ongoing insurance obligations. The ratings are not assigned to specific insurance policies or contracts and do not address any other risk, including, but not limited to, an insurer's claims-payment policies or procedures; the ability of the insurer to dispute or deny claims payment on grounds of misrepresentation or fraud; or any specific liability contractually borne by the policy or contract holder. A Best's Financial Strength Rating is not a recommendation to purchase, hold or terminate any insurance policy, contract or any other financial obligation issued by an insurer, nor does it address the suitability of any particular policy or contract for a specific purpose or purchaser. In arriving at a rating decision, A.M. Best relies on third-party audited financial data and/or other information provided to it. While this information is believed to be reliable, A.M. Best does not independently verify the accuracy or reliability of the information. For additional details, see A.M. Best's *Terms of Use* at [www.ambest.com](http://www.ambest.com).

Best's Financial Strength Ratings are distributed via press release and/or the A.M. Best Web site at [www.ambest.com](http://www.ambest.com) and are published in the *Rating Actions* section of *BestWeek*®. Best's Financial Strength Ratings are proprietary and may not be reproduced without permission.  
Copyright © 2010 by A.M. Best Company, Inc. Version 041410

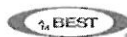

**COUNTY OF MACON – PROPERTY & INLAND MARINE  
CLIENT AUTHORIZATION TO BIND COVERAGE**

After careful consideration of your proposal dated 12/12/2013, we accept your insurance program subject to the following exceptions/changes:

**POLICY OPTIONS:**

YES	NO	OPTION DESCRIPTION
		<b>Bind All Policies As Shown Herein Except As Listed Below:</b>
		<b>Bind TRIA Terrorism Coverage As Quoted Except For the Following Policies</b>
		<b>Provide Quotations or Additional Information on the following Coverage Considerations</b>

It is understood this proposal provides only a summary of the details; the policies will contain the actual coverages.

We confirm the values, schedules, and other data contained in the proposal are from our records and acknowledge it is our responsibility to see that they are maintained accurately.

We agree that your liability to us arising from your negligent acts or omissions, whether related to the insurance placed pursuant to these binding instructions or not, shall not exceed \$20 million, in the aggregate. Further, without limiting the foregoing, we agree that in the event you breach your obligations, you shall only be liable for actual damages we incur and that you shall not be liable for any indirect, consequential or punitive damages.

\_\_\_\_\_  
Client Signature

\_\_\_\_\_  
Dated

**County of Macon**  
**February 1, 2014-2015 Term**  
**Statement of Values**

Loc	Address	Occupancy	Limits		Yr Blt	Const	Stories	Bsmt	Sq Ft
			Bldg.	BPP					
1-1	253 E. Wood St.	County Courthouse Building	\$ -	\$ 365,500	1930	Masonry	5	Yes	97,495
2-1	2405 N. Woodford Ave.	Highway Garage	\$ 1,337,000	\$ 260,000	1989	Steel & Brick	1	No	12,000
3-1	2405 N. Woodford Ave.	Highway Storage	\$ 1,188,100	\$ 224,500	1944	Masonry	1	No	11,100
4-1	2405 N. Woodford Ave.	Highway Radio Station	\$ 3,900	\$ 12,000	1960	Masonry	1	No	64
5-1	2405 N. Woodford Ave.	Highway Garage	\$ 2,413,100	\$ 94,700	2003	Masonry	1	No	25,000
		Highway Dept.	\$ 4,942,100	\$ 591,200					
7-1	333 S. Franklin St.	Law Enforcement Center	\$ -	\$ 186,700	1988	Masonry	3	1	138,536
8-1	1221 E. Condit	Health Dept. Offices	\$ 5,136,000	\$ 500,000	1991	Masonry	1	Slab	37,585
9-1	141 S. Main St.	County Admin Offices	\$ -	\$ 299,000	1960	Masonry	8	Yes	78,121
10-1	141 S. Main St. , Ste. 810	911 Office ①	\$ -	\$ 101,000	1960	Masonry	8	Yes	4,880
11-1	2121 S. Imboden St.	Solid Waste (Paint) Disposal Facility ②	\$ -	\$ 29,900	1940	Metal / Frame	1		1,500
12-1	2627 N. Woodford Ave.	Highway Dept. Salt Storage Shed	\$ 390,100	\$ -	2001	Frame	1	No	8,050
13-1	2820 E. Parkway Dr.	Animal Shelter	\$ -	\$ 106,700	1978	Masonry	1	No	13,148
14-1	2820 E. Parkway Dr.	Animal Shelter/Pole Barn	\$ -	\$ 12,000	1978	Metal Pole Bldg	1	No	
		Animal Shelter	\$ -	\$ 118,700					
<b>Blanket Limits</b>			<b>\$ 10,468,200</b>	<b>\$ 2,192,000</b>					
			<b>\$</b>	<b>12,660,200</b>					

① This office is in building #9

② This is an "Industrial Incubator"

Insured's Signature \_\_\_\_\_

Date \_\_\_\_\_

**County of Macon - Inland Marine Schedule  
2014 - 2015 Policy Term**

Dept	Year	Make	Model	Serial Number	Value	
Zone/Plan	2004		MS-400 Digital Scanner w/lens, fiche carrier, paper cassette	AB307299	\$ 5,523.00	
Circuit Clerk	2004		Mobile Shelving		\$ 13,950.00	
			Kodak-Imagelink Microimage 70		\$ 20,000.00	
Coroner		Arctic	Body Drawer		\$ 9,000.00	
County Clerk	2004		Ballot On Demand Printer HP9000DN	JPBQY05021	\$ 5,050.00	
			Ballot Counter		\$ 7,500.00	
			50 Polling Booths-\$400.00 each		\$ 20,000.00	
			50-6' tables/\$130.00 each		\$ 6,500.00	
			160 stacker chairs		\$ 15,200.00	
			Pollmaster 1 Voting Booths-without lights (quantity 350)		\$ 76,940.00	
			Pollmaster 1 ADA Voting Booths-without lights(quantity 20)			
	1980	Magic Tilt	Boat Trailer	1196965	\$ 500.00	
	1993	Home Made	Elec. Plant Trailer, Black			
	1994	Haul Rite	LJ-700 Boat Trailer	19BEG1117QCF40337	\$ 100.00	
	2004		Mobile Shelving		\$ 13,950.00	
Highway	1991	International	Etnyre Distributor 3,500 Gal. 45,000 GVW	HTSHNGT7MH31124	\$ 80,000.00	
	1997	John Deere	644G Loader w/12' one-way plow 178 HP	DW644GB563899	\$ 75,000.00	
	1997	John Deere	744H Loader w/14' V-plow 260 HP	DW744HX563939	\$ 100,000.00	
	2002	John Deere	722CH Motor Grader w/12' V-plow 40,000 GVW	Dw772CH584373	\$ 95,000.00	
	2002	John Deere	722CH Motor Grader w/12' V-plow 40,000 GVW	DW772CH584391	\$ 95,000.00	
	2002	Caterpillar	430D Backhoe/Loader 93HP	BML02373	\$ 45,000.00	
	1995	Badger	F Cruz Air Excavator	950605	\$ 34,000.00	
	1990	Caterpillar	Rubber Tired Roller 10 Ton Static	LDA1132UO98-186	\$ 32,000.00	
	2001	Etnyre	Chip Spreader	K5837	\$ 75,000.00	
	2003	Caterpillar	CB224D Steel Drum Roller	8R201413	\$ 25,000.00	
	1998	Ram	30/50 Wood Chipper	KZW001A	\$ 18,000.00	
	1992	Caterpillar	78" Steel Vibratory Roller 10 Ton 210 HP	7CD00147	\$ 28,000.00	
	1950	ABSCO	Widener 100 HP	115-1950	\$ 1,500.00	
	1995	Sewer Equip. Jetter	w/trailer 750 Gal. 140 HP	6637	\$ 10,000.00	
	1998	John Deere	Tractor w/7' mower 60 HP	LV53105132010	\$ 6,800.00	
	1987	John Deere	Tractor w/5' mower 56 HP	CD4239D741570	\$ 4,600.00	
	1995	John Deere	Tractor w/Bat Wing mower 60 HP	LV5400E442067	\$ 5,500.00	
	1997	John Deere	Tractor w/Bat Wing mower 60 HP	LV5400E641520	\$ 6,200.00	
	1997	John Deere	Tractor w/Bat Wing mower 60 HP	LV5400E641517	\$ 6,200.00	
	1986	Ingersoll-Rand	Air Compressor 175 ccf w/hoses and tools	156422-6686-959	\$ 7,500.00	
	1990	MB	Hand Paint Striper w/12 Gal. Tank	3-0872	\$ 600.00	
			Homelite	Generator 5500 Watt	9404051B	\$ 400.00
	1995	Homelite	Trash Pump 16 HP 4"	9404062B	\$ 850.00	
	1972	Gorman-Rupp	Pump 12 HP 3" Trash	13A2-S12D	\$ 500.00	
	1996		Vibrating Plate compactor 7.5 HP	3973326	\$ 1,000.00	
	1996	Target Pact IV	Concrete Saw 14 HP	235464	\$ 1,200.00	
	1996	DeVilbiss	Generator 10 HP 5 KW	9612011876	\$ 400.00	
	1992	Schmidt	Sandblaster 300 lb.	L294	\$ 3,500.00	
	1951	Cleaver-Brooks	Booster Pump 50 HP	2967-50	\$ 1,000.00	
	1974	Calenco	Porta Pug Mixer 80 HP 300 Ton/hr.	26789	\$ 2,500.00	
	1972	Miller	Welder 225 Amp Gas		\$ 850.00	
	2004	Hewlett-Packard	Designjet 815 mfp HP CAD Bundle new		\$ 17,756.00	
	2005	John Deere	Skid/Steer/Loader CT332	T0332TB116179	\$ 60,800.00	
	2009	John Deere	Wheel Loader, mdl. 644K	DW644KZ623439	\$ 155,500.00	



Dept	Year	Make	Model	Serial Number	Value
Highway			Bulb eater/bulb crusher, mdl. AIRC330-010		\$ 3,500.00
		Cycle Max	Transporter		\$ 5,000.00
		Pro-Tainer	Recycling Box (quantity 4/\$5000.00 each)		\$ 20,000.00
	1984	Laundau	14 ft boat, mdl 1456, /20 HP motor	L8006891M84G	
		Fisher	16' boat, mdl 1619, 20 HP motor	39FXA393	
		John Deere	4 WD utility tractor w/cab		\$ 45,005.00
		John Deere	4 WD utility tractor w/cab		\$ 45,005.00
		Bush Hog	3715 flex wing rotary cutters 15 ft heavy duty		\$ 13,758.00
	2009	Caterpillar	self-propelled road sweeper		\$ 41,930.00
	2010	Caterpillar	430E IT 4 WD Backhoe Loader w/laser&site ref system		\$ 103,670.00
	2012	Schulte	XH1500 15' flex wing rotary cutter, 540 oto walking axles, 8 wheels	C30611175207	\$ 19,497.50
	2012	Schulte	XH1500 15' flex wing rotary cutter, 540 oto walking axles, 8 wheels	C30611176207	\$ 19,497.50
Health			(5) Fully equipped exam rooms \$5000 each		\$ 25,000.00
			(4) Fully equipped exam rooms \$3000 each		\$ 12,000.00
		Onan	Electric Polisher, Elite 125	T1800633-0519	\$ 7,000.00
Recorder		3M	2600 AU Processor Camera	43244	\$ 5,000.00
		3M	664AG 630 Reader	214111	\$ 8,000.00
Sheriff	2003	Krimesight	Mager & camera kit	KSS6996	\$ 18,337.00
	2004		8 Panel Tactical Blanket w/3 suction cup straps		\$ 7,992.20
		80 Series	Kardveyer Roll-A-Dex(large)	3679	\$ 5,000.00
		NEC	Fingerprint Scanner TP600	500	\$ 10,000.00
		Lexmark	Printer for Fingerprint Scanner T610		
Solid Waste	1999	Geneva	RS-18EPS Recycling Separator	#BEUS1813UVNMC134	
	2000	Protrailer B	Trailer	1P9RB2220YA371070	
	2000	Protrailer B	Trailer	1P9RB2222YA371071	
	2000	Protrailer B	Trailer	1P9RB2224YA371072	
	2009	Pro-Tainer	RDB for PROS-16TR 16 cubic yard/1 internal swing divider/14'		\$ 5,017.00
	2009	Pro-Tainer	RDB for PROS-16TR 16 cubic yard/1 internal swing divider/14'		\$ 5,017.00
	2012	Middlebury	Trailer 6' x 12' white w/tandem axles, double rear doors		\$ 3,340.00
	2013	Pro-Tainer	PROS-16TR-Pro-Roll off 16 bumper pole trailer w/extra pendant control	1P9PRS160CA277366	\$ 18,839.00
Voting Machines - \$5100 Each					\$ 464,100.00
<b>Total Inland Marine Value</b>					<b>\$ 2,102,874.20</b>



UNITED FIRE & CASUALTY COMPANY  
PO Box 73909, Cedar Rapids, IA 52407

---

QUOTE NO: 0105 01431932

EFFECTIVE: 02/01/2014 — 02/01/2015  
RATED ON: 12/19/2013

CLIENT: COUNTY OF MACON  
141 S MAIN ST STE 312  
DECATUR IL 62523-1274

AGENT: 330272 ARTHUR J GALLAGHER  
PO BOX 140  
DECATUR IL 62523

QUOTE SUMMARY

COVERAGE	PREMIUM
INLAND MARINE	11,222.00
COMMERCIAL PROPERTY	12,844.00
TOTAL PREMIUM FOR QUOTE	24,066.00

---

**NOTE:** This quotation should be considered an estimate and not binding. If a policy is issued by the Company, premiums and coverage may vary from the original quote. Please refer to the actual policy for complete details. All policy provisions and premiums shall prevail over this quote. This quote is valid for 60 days.





UNITED FIRE & CASUALTY COMPANY  
 PO Box 73909, Cedar Rapids, IA 52407

QUOTE NO: 0105 01431932

EFFECTIVE: 02/01/2014 — 02/01/2015  
 RATED ON: 12/19/2013

CLIENT: COUNTY OF MACON  
 141 S MAIN ST STE 312  
 DECATUR IL 62523-1274

AGENT: 330272 ARTHUR J GALLAGHER  
 PO BOX 140  
 DECATUR IL 62523

**Commercial Property**

EQUIPMENT BREAKDOWN			445
ULTRA PROPERTY PLUS			523
BUS INC INCL RENTAL VALUE-W/ EE	250,000		Incl
WATER BACKUP	10,000		Incl

BLANKET #01-Applies to the following coverages	2,192,000	.131	2,861
at Premises #01 Building #01			
YOUR BUSINESS PERSONAL PROP			
at Premises #02 Building #01			
YOUR BUSINESS PERSONAL PROP			
at Premises #02 Building #02			
YOUR BUSINESS PERSONAL PROP			
at Premises #02 Building #03			
YOUR BUSINESS PERSONAL PROP			
at Premises #02 Building #04			
YOUR BUSINESS PERSONAL PROP			
at Premises #03 Building #01			
YOUR BUSINESS PERSONAL PROP			
at Premises #04 Building #01			
YOUR BUSINESS PERSONAL PROP			
at Premises #05 Building #01			
YOUR BUSINESS PERSONAL PROP			
at Premises #05 Building #02			
YOUR BUSINESS PERSONAL PROP			
at Premises #06 Building #01			
YOUR BUSINESS PERSONAL PROP			
at Premises #08 Building #01			
YOUR BUSINESS PERSONAL PROP			
at Premises #08 Building #02			
YOUR BUSINESS PERSONAL PROP			

BLANKET #02-Applies to the following coverages	10,468,200	.075	7,826
at Premises #02 Building #01			
BUILDING			
at Premises #02 Building #02			
BUILDING			
at Premises #02 Building #03			
BUILDING			
at Premises #02 Building #04			
BUILDING			
at Premises #04 Building #01			
BUILDING			
at Premises #07 Building #01			
BUILDING			

01 01 253 E WOOD ST  
 DECATUR IL 62523-1483  
 FRAME  
 COUNTY COURTHOUSE BUILDING

YOUR BUS PERSONAL PROP		Incl	Incl	Incl
Special Causes of Loss	2,500 Ded			
Replacement Cost	90% Coins			

	4% Inflation Guard				
	YOUR BUS PERSONAL PROP - EARTHQUAKE		365,500	.005	18
	10% Ded				
02 01	2405 N WOODFORD ST				
	DECATUR IL 62526-4704				
	MODIFIED FIRE RESISTIVE				
	HIGHWAY GARAGE				
	BUILDING		Incl	Incl	Incl
	Special Causes of Loss	2,500 Ded			
	Replacement Cost	90% Coins			
	Automatic Valuation Adjustment				
	BUILDING - EARTHQUAKE		1,337,000	.007	94
	10% Ded				
	YOUR BUS PERSONAL PROP		Incl	Incl	Incl
	Special Causes of Loss	2,500 Ded			
	Replacement Cost	90% Coins			
	4% Inflation Guard				
	YOUR BUS PERSONAL PROP - EARTHQUAKE		260,000	.005	13
	10% Ded				
02 02	2405 N WOODFORD ST				
	DECATUR IL 62526-4704				
	JOISTED MASONRY				
	HIGHWAY STORAGE				
	BUILDING		Incl	Incl	Incl
	Special Causes of Loss	2,500 Ded			
	Replacement Cost	90% Coins			
	Automatic Valuation Adjustment				
	BUILDING - EARTHQUAKE		1,188,100	.007	83
	10% Ded				
	YOUR BUS PERSONAL PROP		Incl	Incl	Incl
	Special Causes of Loss	2,500 Ded			
	Replacement Cost	90% Coins			
	4% Inflation Guard				
	YOUR BUS PERSONAL PROP - EARTHQUAKE		224,500	.005	11
	10% Ded				
02 03	2405 N WOODFORD ST				
	DECATUR IL 62526-4704				
	JOISTED MASONRY				
	HIGHWAY RADIO STATION				
	BUILDING		Incl	Incl	Incl
	Special Causes of Loss	2,500 Ded			
	Replacement Cost	90% Coins			
	Automatic Valuation Adjustment				
	BUILDING - EARTHQUAKE		3,900	.007	1
	10% Ded				
	YOUR BUS PERSONAL PROP		Incl	Incl	Incl
	Special Causes of Loss	2,500 Ded			
	Replacement Cost	90% Coins			
	4% Inflation Guard				
	YOUR BUS PERSONAL PROP - EARTHQUAKE		12,000	.005	1
	10% Ded				
02 04	2405 N WOODFORD ST				
	DECATUR IL 62526-4704				
	JOISTED MASONRY				
	HIGHWAY GARAGE				
	BUILDING		Incl	Incl	Incl
	Special Causes of Loss	2,500 Ded			
	Replacement Cost	90% Coins			
	Automatic Valuation Adjustment				
	BUILDING - EARTHQUAKE		2,413,100	.006	145
	10% Ded				
	YOUR BUS PERSONAL PROP		Incl	Incl	Incl
	Special Causes of Loss	2,500 Ded			
	Replacement Cost	90% Coins			

	4% Inflation Guard				
	YOUR BUS PERSONAL PROP - EARTHQUAKE		94,700	.005	5
		10% Ded			
03 01	333 S FRANKLIN ST				
	DECATUR IL 62523-1352				
	FIRE RESISTIVE				
	LAW ENFORCEMENT CENTER				
	YOUR BUS PERSONAL PROP		Incl	Incl	Incl
	Special Causes of Loss	2,500 Ded			
	Replacement Cost	90% Coins			
	4% Inflation Guard				
	YOUR BUS PERSONAL PROP - EARTHQUAKE		186,700	.005	9
		10% Ded			
04 01	1221 E CONDIT ST				
	DECATUR IL 62521-1405				
	FIRE RESISTIVE				
	HEALTH DEPARTMENT OFFICES				
	BUILDING		Incl	Incl	Incl
	Special Causes of Loss	2,500 Ded			
	Replacement Cost	90% Coins			
	Automatic Valuation Adjustment				
	BUILDING - EARTHQUAKE		5,136,000	.007	360
		10% Ded			
	YOUR BUS PERSONAL PROP		Incl	Incl	Incl
	Special Causes of Loss	2,500 Ded			
	Replacement Cost	90% Coins			
	4% Inflation Guard				
	YOUR BUS PERSONAL PROP - EARTHQUAKE		500,000	.005	25
		10% Ded			
05 01	141 S MAIN ST				
	DECATUR IL 62523-1200				
	FIRE RESISTIVE				
	COUNTY ADMIN OFFICES				
	YOUR BUS PERSONAL PROP		Incl	Incl	Incl
	Special Causes of Loss	2,500 Ded			
	Replacement Cost	90% Coins			
	4% Inflation Guard				
	YOUR BUS PERSONAL PROP - EARTHQUAKE		299,000	.005	15
		10% Ded			
05 02	141 S MAIN ST STE 810				
	DECATUR IL 62523-6051				
	FIRE RESISTIVE				
	911 OFFICE				
	YOUR BUS PERSONAL PROP		Incl	Incl	Incl
	Special Causes of Loss	2,500 Ded			
	Replacement Cost	90% Coins			
	4% Inflation Guard				
	YOUR BUS PERSONAL PROP - EARTHQUAKE		101,000	.005	5
		10% Ded			
06 01	2121 S IMBODEN CT				
	DECATUR IL 62521-5286				
	JOISTED MASONRY				
	SOLID WASTE (PAINT) DISP FACIL				
	YOUR BUS PERSONAL PROP		Incl	Incl	Incl
	Special Causes of Loss	2,500 Ded			
	Replacement Cost	90% Coins			
	4% Inflation Guard				
	YOUR BUS PERSONAL PROP - EARTHQUAKE		29,900	.005	1
		10% Ded			
07 01	2627 N WOODFORD ST				
	DECATUR IL 62526				

FRAME  
HIGHWAY DEPT SALT STORGE SHED

BUILDING		Incl	Incl	Incl
Special Causes of Loss	2,500 Ded			
Replacement Cost	90% Coins			
Automatic Valuation Adjustment				
BUILDING - EARTHQUAKE		390,100	.006	23
	10% Ded			

08 01 2820 E PARKWAY DR  
DECATUR IL 62526-5230  
FRAME  
ANIMAL SHELTER

YOUR BUS PERSONAL PROP		Incl	Incl	Incl
Special Causes of Loss	2,500 Ded			
Replacement Cost	90% Coins			
4% Inflation Guard				
YOUR BUS PERSONAL PROP - EARTHQUAKE		106,700	.005	5
	10% Ded			

08 02 2820 E PARKWAY DR  
DECATUR IL 62526-5230  
FRAME  
ANIMAL SHELTER/POLE BARN

YOUR BUS PERSONAL PROP		Incl	Incl	Incl
Special Causes of Loss	2,500 Ded			
Replacement Cost	90% Coins			
4% Inflation Guard				
YOUR BUS PERSONAL PROP - EARTHQUAKE		12,000	.005	1
	10% Ded			

Certified Acts of Terrorism Coverage 374

FORMS ON QUOTE

CP0010	0607	BLDG & PERSONAL PROP COVG FORM
CP0090	0788	COMM PROP CONDITIONS
CP0140	0706	EXCL OF LOSS DUE TO VIRUS/BACTERIA
CP0149	0607	ILLINOIS-CHGS-ARTIFICIALLY GENERATED ELEC CURRENT
CP1030	0607	CAUSES OF LOSS-SPECIAL FORM
CP1032	0808	WATER EXCL END
CP1040	0899	EQ & VOLCANIC ERUPTION END
CP7003	1186	AUTOMATIC VALUATION ADJUSTMENT-APPLIES TO BLDG
CP7067	0212	EQUIP BREAKDOWN ENHANCEMENT END
CP7088	1013	ULTRA PROP PLUS
IL0017	1198	COMMON POLICY CONDITIONS
IL0118	1010	IL-CHGS
IL0162	0908	IL-CHGS DEFENSE COSTS
IL0284	1205	IL-CHGS CANCEL & NONRENEW
IL0952	0308	CAP ON LOSSES FROM CERTIFIED ACTS OF TERRORISM
IL7083	0810	PAYMENT OF LOSSES
ST0013	0508	EQUIPMENT BREAKDOWN STUFFER
ST1236	1197	IL-DEPARTMENT OF INSURANCE
ST1644	0112	POLICY WEBSITE STUFFER
ST1646	0309	NOTICE-IMPORTANT-SECURITY
ST1728	0712	DISCLOSURE FOR EQUIP BREAKDOWN

**Total Estimated Premium: 12,844.00**

**NOTE:** This quotation should be considered an estimate and not binding. If a policy is issued by the Company, premiums and coverage may vary from the original quote. Please refer to the actual policy for complete details. All policy provisions and premiums shall prevail over this quote. This quote is valid for 60 days.



UNITED FIRE & CASUALTY COMPANY  
 PO Box 73909, Cedar Rapids, IA 52407

QUOTE NO: 0105 01431932

EFFECTIVE: 02/01/2014 — 02/01/2015  
 RATED ON: 12/19/2013

CLIENT: COUNTY OF MACON  
 141 S MAIN ST STE 312  
 DECATUR IL 62523-1274

AGENT: 330272 ARTHUR J GALLAGHER  
 PO BOX 140  
 DECATUR IL 62523

**Inland Marine**

Form/ Coverage CM7045 CONTRACTORS INSTALL/EQUIP/UNSHLD EQUIP	Deduct	Limit of Insurance	Premium
			10,895

Contractors Equipment  
 Item Description

Item Description	Deduct	Limit of Insurance	Premium
001 04 MS-400 DIGITAL SCANNER #AB307299	1,000	5,523	
002 04 MOBILE SHELVING	1,000	13,950	
003 KODAK IMAGING MICROIMAGE 70	1,000	20,000	
004 ARCTIC BODY DRAWER	1,000	9,000	
005 04 BALLOT ON DEMAND PRINTER #JPBQY0502	1,000	5,050	
006 BALLOT COUNTER	1,000	7,500	
007 50 POLLING BOOTHS @ \$400 EACH	1,000	20,000	
008 50-6' TABLES @ \$130 EACH	1,000	6,500	
009 160 STACKER CHAIRS	1,000	15,200	
010 POLLMASTER 1 VOTING BOOTHS WOUT LIGHTS	1,000	76,940	
011 80 MAGIC TILT BOAT TRAILER #1196965	1,000	500	
012 94 HAUL RITE LJ-700 BOAT TRAILER #0337	1,000	100	
013 04 MOBILE SHELVING	1,000	13,950	
014 91 INTERNATIONAL ENTYRE DIST GAL 45K	1,000	80,000	
015 97 JD 644G LOADER W PLOW #3899	1,000	75,000	
016 97 JD 744H LOADER W PLOW #3939	1,000	100,000	
017 02 JD 722CH MOTOR GRADER W PLOW #4373	1,000	95,000	
018 02 JD 722CH MOTOR GRADER W PLOW #4391	1,000	95,000	
019 02 CATERPILLAR 430D BACKHOE.LDR #2373	1,000	45,000	
020 95 BADGER F CRUZ AIR EXCAVATOR #950605	1,000	34,000	
021 90 CATERPILLAR RUBBER TIRED ROLLER #86	1,000	32,000	
022 01 ENTYRE CHIP SPREADER #K5837	1,000	75,000	
023 03 CATERPILLAR CB224D STEEL DRUM ROLLE	1,000	25,000	
024 98 RAM 30/50 WOOD CHIPPER #K7W001A	1,000	18,000	
025 92 CATERPILLAR 78" STEEL VIBRATORY ROL	1,000	28,000	
026 50 ABSCO WIDENER 100HP #115-1950	1,000	1,500	
027 95 SEWER EQUIP JETTER W TRAILER	1,000	10,000	
028 98 JD TRACTOR W MOWER #LV53105132010	1,000	6,800	
029 87 JD TRACTOR W MOWER 56HP #1570	1,000	4,600	
030 95 JD TRACTOR W MOWER 60HP #2067	1,000	5,500	
031 97 JD TRACTOR W MOWER 60HP #1520	1,000	6,200	
032 97 JD TRACTOR W MOWER 60HP #1517	1,000	6,200	
033 86 INGERSOLL RAND AIR COMPRESSOR #959	1,000	7,500	
034 90 HAND PAINT STRIPER #3-0872	1,000	600	
035 HOMELITE GENERATOR 5500 WATT #9404051B	1,000	400	
036 95 HOMELITE TRASH PUMP 16HP #9404062B	1,000	850	
037 72 GORMAN-RUPP PUMP 12HP 3" TRASH #12D	1,000	500	
038 96 VIBRATING PLATE COMPACTOR 7.5HP #26	1,000	1,000	
039 96 TARGET PACT IV CONCRETE SAW 14HP	1,000	1,200	
040 DEVILBISS GENERATOR 10HP 5 KW #1876	1,000	400	
041 92 SCHMIDT SANDBLASTER 300LB #L294	1,000	3,500	
042 51 CLEAVER-BROOKS BOOSTER PUMP 50HP	1,000	1,000	
043 74 CALENCO PORTA PUG MIXER 80HP	1,000	2,500	
044 72 MILLER WELDER 225 AMP GAS	1,000	850	
045 04 HEWLETT-PACKARD DESIGNJET 815 MFP H	1,000	17,756	

046	05 JD SKID STEER LOADER #116179	1,000	60,800
047	09 JD WHEEL LOADER #DW644KZ623439	1,000	155,500
048	BULB EATER BULB CRUSHER #330-010	1,000	3,500
049	CYCLE MAX TRANSPORTER	1,000	5,000
050	PRO TAINER RECYCLING BOX (4) @5K EACH	1,000	20,000
051	JD 4 WD UTILITY TRACTOR	1,000	45,005
052	JD 4WD UTILITY TRACTOR	1,000	45,005
053	BUSH HOG 3715 FLEX ROTARY CUTTERS	1,000	13,758
054	09 CATERPILLAR SELF PROPELLED ROAD SWP	1,000	41,930
055	10 CATERPILLAR 430E IT BACKHOE LOADER	1,000	103,670
056	12 SCHULTE XH1500 15' ROTARY CUTTER	1,000	19,498
057	12 SCHULTE XH1500 ROTARY CUTTER #76207	1,000	19,497
058	(5) FULLY EQUIPPED EXAM ROOMS 5K EACH	1,000	25,000
059	(4) FULLY EQUIPPED EXAM ROOMS 3K EACH	1,000	12,000
060	ONAN ELECTRIC POLISHER ELITE 125 #0519	1,000	7,000
061	3M 2600 AU PROCESSOR CAMERA #43244	1,000	5,000
062	3M 664AG 630 READER #214111	1,000	8,000
063	03 KRIMESIGHT MAGER & CAMERA KIT	1,000	18,337
064	04 8 PANEL TACTICAL BLANKET W STRAPS	1,000	7,992
065	80 SERIES KARDVEYER ROLL A DEX (LARGE)	1,000	5,000
066	LEXMARK PRINTER & NEC FINGER PRINT SCN	1,000	10,000
067	09 PRO TAINER INTERNAL SWIND DIVIDER	1,000	5,017
068	09 PRO TAINER INTERNAL SWING DIVIDER	1,000	5,017
069	12 MIDDLEBURY TRAILER	1,000	3,340
070	13 PRO TAINER ROLL OFF BUMPER POLE TRL	1,000	18,839
071	VOTING MACHINES \$5100 EACH	1,000	464,100

Total Limit for Items

2,102,874

In the event of a loss involving more than one item, the highest deductible will apply to the entire loss.

Coinsurance 80%

Unscheduled Equipment

1,000

Most We Will Pay Any One Loss

10,000

Most We Will Pay Any One Item

5,000

Certified Acts of Terrorism Coverage

327

FORMS ON QUOTE

CL-300	0295	AMENDATORY END
CL0100	0399	COMMON POLICY CONDITIONS
CL0120	1008	IL-AMENDATORY END
CL0600	0108	CERTIFIED TERRORISM LOSS
CL0700	1006	VIRUS OR BACTERIA EXCL
IL7083	0810	PAYMENT OF LOSSES
IM2027	0809	IL-AMENDATORY END
ST1236	1197	IL-DEPART OF INSURANCE ADDRESS
ST1644	0112	POLICY WEBSITE STUFFER

**Total Estimated Premium: 11,222.00**

**NOTE:** This quotation should be considered an estimate and not binding. If a policy is issued by the Company, premiums and coverage may vary from the original quote. Please refer to the actual policy for complete details. All policy provisions and premiums shall prevail over this quote. This quote is valid for 60 days.

**MACON COUNTY BOARD RESOLUTION  
SETTING THE SALARY FOR  
OFFICE OF COUNTY CLERK  
ELECTED 2014-2018**

**RESOLUTION NO. G- 4027-1-14**

**WHEREAS**, the Operations and Personnel Committee met on December 16, 2013 and the Finance Committee met on December 30, 2013 and both recommended setting the following salary for the office of County Clerk elected 2014 – 2018:

	<u>2013-2014</u>	<u>2014-2015</u>	<u>2015-2016</u>	<u>2016-2017</u>	<u>2017-2018</u>
		(7%)	(7%)	(3%)	(3%)
County Clerk	\$72,412.89	\$77,482.86	\$82,906.66	\$85,393.86	\$87,955.68

**NOW, THEREFORE, BE IT RESOLVED** by the Macon County Board that it hereby approves the salaries listed above for the office of County Clerk elected 2014 – 2018.

**BE IT FURTHER RESOLVED** by the Macon County Board that this resolution shall become effective December 1, 2014.

**PRESENTED, PASSED and APPROVED** this 9<sup>th</sup> day of January, 2014.

AYES \_\_\_\_\_ NAYS \_\_\_\_\_

MACON COUNTY BOARD  
MACON COUNTY, ILLINOIS

ATTEST:

BY:

\_\_\_\_\_  
Stephen M. Bean, Clerk for the  
County of Macon, State of Illinois

\_\_\_\_\_  
Jay A. Dunn, Chairman  
Macon County Board

Office	2013-2014	%	2014-2015	%	2015-2016	%	2016-2017	%	2017-2018
Auditor	\$ 79,901.14	2.00%	\$ 81,499.44	2.50%	\$ 83,536.93		TBD		TBD
Circuit Clerk	\$ 79,901.14	2.00%	\$ 81,499.44	2.50%	\$ 83,536.93		TBD		TBD
Coroner	\$ 79,901.14	2.00%	\$ 81,499.44	2.50%	\$ 83,536.93		TBD		TBD
Recorder	\$ 79,901.14	2.00%	\$ 81,499.44	2.50%	\$ 83,536.93		TBD		TBD
Sheriff	\$ 77,272.05	7.00%	\$ 82,681.09	7.00%	\$ 88,468.77	3.00%	\$ 91,122.83	3.00%	\$ 93,856.52
Clerk	\$ 72,413.89	7.00%	\$ 77,482.86	7.00%	\$ 82,906.66	3.00%	\$ 85,393.86	3.00%	\$ 87,955.68

FY13 County Clerk Salary Comparisons					
Champaign	McLean	Sangamon	Peoria	DeKalb	Macon
\$ 92,000.00	\$ 90,818.00	\$ 98,000.00	\$ 92,362.00	\$ 88,513.00	\$ 87,454.00
Does not handle City of Bloomington	Does not handle City of Peoria	Does not handle City of Peoria	Does not handle City of Peoria		
yes	yes	yes	yes	yes	yes

Does their office Handle City Elections?

- Additional election duties added on by both the federal and state government in the past 8 years
- Early voting hours have been extended and include Sunday
- There are after election duties for two weeks after the election.
- In 2008, the Recorder, Auditor, Coroner and Circuit Clerk got a 15.94% raise and two years later, the Treasurer, Sheriff & County Clerk got zero
- Beginning with the Consolidation Election of 2015, the County Clerk will handle the petitions and filings for all school districts headquartered in Macon County

Per Steve Bean, As of 12/1/13, the Champaign Clerk went over \$92,000



**MACON COUNTY BOARD RESOLUTION  
APPROVING A BUDGET AMENDMENT FOR  
WORKFORCE INVESTMENT SOLUTIONS FY'13 & FY'14 BUDGETS  
Trade Adjustment Assistance Grant**

**RESOLUTION NO. G-4028-1-14**

**WHEREAS**, the Operations & Personnel Committee met on December 16, 2013 and Finance Committee met on December 30, 2013 and were presented with a request to amend the Workforce Investment Solutions budget for FY'13 and FY'14; and

**WHEREAS**, Workforce Investment Solutions has received a modification for the Trade Adjustment Assistance Grant No. 11-661019 from the Department of Commerce and Economic Opportunity in the amount of \$2,270.76 for the period of January 1, 2012 – September 30, 2013 and a grant modification for Trade Adjustment Assistant Grant No. 12-661019 in the amount of \$11,565.92 for the period of December 1, 2013 – September 30, 2014; and

**WHEREAS**, this grant is included in Workforce Investment Solutions Fund 150 and assigned Department 047-11 and Department 047-12; and

**WHEREAS**, an emergency exists whereby if the budget is not amended, valuable grant funds will be lost.

**NOW, THEREFORE, BE IT RESOLVED** by the Macon County Board that it hereby approves amending the Workforce Investment Solutions FY13 Budget and FY'14 Budget as follows:

**FY'13 Budget**

Increased Revenue:	A150-047-4360-11	\$2,270.76
Increased Expenses:	A150-047-7540-11-35-0-000	\$ 2,270.76 (Trnsp)

**FY'14 Budget**

Increased Revenue:	A150-047-4360-12	\$11,565.92
Increased Expenses:	A150-047-5597-12-38-0-100	\$ 749.00 (Case Mgr Wage)
	A150-047-7190-12-35-0-000	\$ 2,000.00 (Training)
	A150-047-7540-12-35-0-000	\$8,816.92 (Trnsp)

**BE IT FURTHER RESOLVED** by the Macon County Board that this resolution shall become effective upon the adoption thereof.

**PRESENTED, PASSED, APPROVED** this 9th day of January, 2014.

AYES \_\_\_\_\_ NAYS \_\_\_\_\_

MACON COUNTY BOARD  
MACON COUNTY, ILLINOIS

ATTEST:

BY:

\_\_\_\_\_  
Stephen M. Bean, Clerk for the  
County of Macon, State of Illinois

\_\_\_\_\_  
Jay Dunn, Chairman  
Macon County Board

**WORKFORCE INVESTMENT  
SOLUTIONS**

*"Workforce development professionals for Macon & DeWitt Counties"*

December 4, 2013

Ms. Crystal Bigelow  
DCEO, Office of Employment & Training  
500 East Monroe, 9<sup>th</sup> Floor  
Springfield, IL 62701-1643

Dear Ms. Bigelow:

**SUBJECT: Grant Application - Grant No. 12-661019  
Macon & DeWitt Counties**

Please consider this letter as a request for Trade Act funding for Grant No. 12-661019 between LWIA 19 and the Department of Commerce and Economic Opportunity. The circumstances related to the request for funding in the amount of \$21,087.68; (i.e. new event was added to grant to pay continued Trade training needs for existing participants) **to be processed in conjunction with Payment Processing distribution in the amount of \$749**; related to the following Trade Event:

- Hostess Brands – TAA Petition #82165L

As CEO, I agree with the information in this request.

Sincerely,

  
Robyn McCoy  
EXECUTIVE DIRECTOR

757 W. Pershing Rd. ▲ Decatur, IL. 62526 ▲ 217/872-5870 ▲ Fax: 217/872-2275

Equal Opportunity Employer Program  
Auxiliary aids and services are available upon request to individuals with disabilities



**MACON COUNTY BOARD RESOLUTION  
 APPROVING A BUDGET AMENDMENT FOR  
 WORKFORCE INVESTMENT SOLUTIONS FY'13 & FY'14 BUDGETS  
 Rapid Response Grant**

**RESOLUTION NO. G-4029-1-14**

**WHEREAS**, the Operations & Personnel Committee met on December 16, 2013 and Finance Committee met on December 30, 2013 and were presented with a request to amend the Workforce Investment Solutions budget for FY'13 & FY'14; and

**WHEREAS**, Workforce Investment Solutions has received a modification for the Rapid Response Grant No. 11-651019 from the Department of Commerce and Economic Opportunity in the amount of \$109,000; and

**WHEREAS**, this grant is included in Workforce Investment Solutions Fund 150 and assigned Department 046-11; and

**WHEREAS**, an emergency exists whereby if the budget is not amended, valuable grant funds will be lost.

**NOW, THEREFORE, BE IT RESOLVED** by the Macon County Board that it hereby approves amending the Workforce Investment Solutions FY14 Budget as follows:

**FY'13 Budget**

Increased Revenue:		\$15,944.33
Increased Expenses:	A150-046-7190-11	\$26,500.57

**FY'14 Budget**

Increased Revenue:		\$93,055.67
Increased Expenses:	A150-046-7190-11-35-0-000	\$ 59,039.02
	A150-046-7196-11-35-0-000	\$ 15,000.00
	A150-046-7540-11-35-0-000	\$ 29,000.00

**BE IT FURTHER RESOLVED** by the Macon County Board that this resolution shall become effective upon the adoption thereof.

**PRESENTED, PASSED, APPROVED** this 9th day of January, 2014.

AYES \_\_\_\_\_ NAYS \_\_\_\_\_

MACON COUNTY BOARD  
 MACON COUNTY, ILLINOIS

ATTEST:

BY:

\_\_\_\_\_  
 Stephen M. Bean, Clerk for the  
 County of Macon, State of Illinois

\_\_\_\_\_  
 Jay Dunn, Chairman  
 Macon County Board

**WORKFORCE INVESTMENT  
SOLUTIONS**

*"Workforce development professionals for Macon & DeWitt Counties"*

December 3, 2013

Ms. Lorraine Wareham  
DCEO, Office of Employment & Training  
500 E. Monroe, 9<sup>th</sup> Floor  
Springfield, IL 62701-1643

Dear Ms. Wareham:

Enclosed is the modification for Grant No. 11-651019 for LWIA #19. This modification reflects an increase of \$250,000, bringing the total grant total to \$811,000.

We received a WARN notice from Caterpillar on April 8, 2013 notifying us that the company plans to lay off supplemental employees effective June 5, 2013. An additional WARN Notice was received from Caterpillar on May 3, 2013 notifying us that the company plans to lay off an additional 299 employees effective July 3, 2013. This mass layoff will affect approximately 760 employees. Workforce Investment Solutions has already began serving individuals from this layoff in April and continues to serve those laid off from this company and the companies listed below.

The events that are for 11-651019 include the following companies:

1. Caterpillar (DETS #20090102002)
2. StarTek (DETS #20120214001)
3. ADM (DETS #20120305001)
4. G&D Integrated, Inc. (DETS #20120619002)
5. Zachry Construction (DETS #20121220001)
6. Hostess Brands (DETS #20130225001)
7. Caterpillar (DETS #20130408001)

As CEO, I agree with the information included in this request.

Thank you,

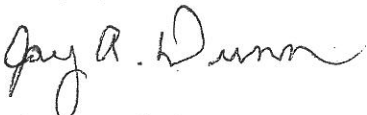

Jay A. Dunn, Chairman  
Macon County Board

Enclosure

757 W. Pershing Rd. ▲ Decatur, IL. 62526 ▲ 217/872-5870 ▲ Fax: 217/872-2275

Equal Opportunity Employer Program  
Auxiliary aids and services are available upon request to individuals with disabilities



**MACON COUNTY BOARD RESOLUTION  
 APPROVING A BUDGET AMENDMENT FOR  
 WORKFORCE INVESTMENT SOLUTIONS FY'13 & FY'14 BUDGETS  
 Summer Youth Employment Program**

**RESOLUTION NO. G-4030-1-14**

**WHEREAS**, the Operations & Personnel Committee met on December 16, 2013 and Finance Committee met on December 30, 2013 and were presented with a request to amend the Workforce Investment Solutions budget for FY'14; and

**WHEREAS**, Workforce Investment Solutions has a grant from the Department of Commerce and Economic Opportunity for the Summer Youth Employment Program Grant No. 13-071032. This resolution increases the grant in the amount of \$71,741.16 for the period of December 01, 2013 – January 31, 2014 and adjusts the FY2013 Budget to reflect actual costs; and

**WHEREAS**, this grant is included in Workforce Investment Solutions Fund 150 and assigned Department 026; and

**WHEREAS**, an emergency exists whereby if the budget is not amended, valuable grant funds will be lost.

**NOW, THEREFORE, BE IT RESOLVED** by the Macon County Board that it hereby approves amending the Workforce Investment Solutions FY13 and FY14 Budget as follows:

**FY'13 Budget**

Decreased Revenue:	A150-026-4360-13	\$21,741.16
Decreased Expenses:	A150-026-5xxx-13	\$11,406.41
	A150-026-7xxx-13	\$ 9,271.52
	A150-026-8xxx-13	\$ 1,063.23

**FY'14 Budget**

Increased Revenue:	A150-026-4360-13	\$ 71,741.16 (Revenue)
Increased Expenses:	A150-026-5001-13-10-0-000	\$ 3,516.11(Director Wages)
	A150-026-5040-13-10-0-000	\$ 8,390.30(Fiscal Asst. Wages)
	A150-026-7410-13-10-0-000	\$ 5,300.00(Contractual)
	A150-026-5597-13-48-0-000	\$ 2,700.00(Case Mgr. Wages)
	A150-026-7121-13-48-0-000	\$ 100.00 (Travel)
	A150-026-7410-13-45-0-000	\$ 10,064.00(Contractual)
	A150-026-7550-13-45-0-000	\$ 44,670.75(Youth W/F/WC)

**BE IT FURTHER RESOLVED** by the Macon County Board that this resolution shall become effective upon the adoption thereof.

**PRESENTED, PASSED, APPROVED** this 9<sup>th</sup> day of January, 2014.

AYES \_\_\_\_\_ NAYS \_\_\_\_\_

ATTEST:

MACON COUNTY BOARD  
 MACON COUNTY, ILLINOIS  
 BY:

\_\_\_\_\_  
 Stephen M. Bean, Clerk for the  
 County of Macon, State of Illinois

\_\_\_\_\_  
 Jay Dunn, Chairman  
 Macon County Board

Illinois Department of Commerce and Economic Opportunity

DCEO GRANT PROGRAM  
REQUEST FOR MODIFICATION/WAIVER\*

GRANTEE NAME: Macon County  
DCEO GRANT#: 13-071032 (the "Agreement")  
GRANT BEGIN DATE: 7/1/2013 GRANT END DATE: 12/31/2013

STEP 1 – A written justification for this modification/waiver must accompany this document.

STEP 2 – Select the Purpose of the Modification/Waiver Requested:

- A. **SCOPE OF WORK** Please attach a revised scope of work with modifications noted.
- B. **BUDGET** On an additional sheet, please present the original budget as well as the revised budget, indicating the requested changes.
- C. **DATE EXTENSION** If you require additional time to complete the scope of work outlined in the Grant Agreement, indicate the date to which you wish to extend the Grant Agreement here: **June 30, 2014**. In addition, please check one of the two boxes below to indicate the type of payment provision applicable to your Grant Agreement:  
 Variable/advance grant only. Grantee acknowledges that it has expended/legally obligated grant funds in performing the Scope of Work required by the Grant Agreement during the original grant term and that, if granted, the extension of time cannot exceed two (2) additional years. Please attach a signed legal obligation document if the extension exceeds the original two year period.  
 Reimbursement grant - Obligation documents not required.
- D. **OTHER** Please check one of the boxes below and attach a separate page identifying the provision(s) that you wish to modify and a written explanation supporting the request for a change.
- Interest Retention:  Payment Provision:
- Audit Waiver:  Waiver of Interest-Bearing Account:
- Other:

To be compliant with Illinois' Comptroller Accounting Bulletin 161, the Grant Agreement shall be amended in accordance with the following. Notwithstanding any language in the existing Grant Agreement to the contrary, the following provisions shall be incorporated into the Grant Agreement:

The Grant Agreement's signature block shall be stricken in its entirety and replaced with the following language:

Grantee's execution of this Agreement shall serve as its certification under oath that Grantee has read, understands and agrees to all provisions of this Agreement and that the information contained in the Agreement is true and correct to the best of his/her knowledge, information and belief and that the Grantee shall be bound by the same. Grantee acknowledges that the individual executing this Agreement is authorized to act on the Grantee's behalf. Grantee further acknowledges that the award of Grant Funds under this Agreement is conditioned upon the above certification.

**Submittal of Reports** Submittal of all reports and documentation required under this Agreement should be submitted to the individual as directed by the Department. Grants in excess of \$25,000 require, at a minimum, the filing of quarterly reports describing the progress of the program, project, or use and the expenditure of the grant funds related thereto.

**Records Retention** This Agreement and all books, records and supporting documents related hereto shall be available for inspection and audit by the Department, the Office of Inspector General, the Auditor General of the State of

Illinois Department of Commerce and Economic Opportunity

DCEO GRANT PROGRAM
REQUEST FOR MODIFICATION/WAIVER\*

Illinois, the Illinois Attorney General or any of their duly authorized representative(s), and the Grantee agrees to fully cooperate with any audit performed by the Auditor General or the Department. Grantee agrees to provide full access to all relevant materials and to provide copies of same upon request.

If the Department approves this request as either a modification or waiver, the Grantee acknowledges and agrees to the following:

- 1. All terms and conditions of the Grant Agreement remain in full force and effect until all performance required by the terms of the agreement are completed.
2. If the period for performance has been extended, the close-out package/final financial status report must be submitted no later than 45 days following any extended performance date.
3. This request is limited to the provisions described herein and in no way impairs the Department's ability to seek legal recourse against the Grantee for non-compliance with either the provisions stated herein or any other provisions of the Agreement.

STEP 3 - Signature

I hereby certify that the supporting documentation for the above modification or waiver request is on file in our office and that I have full signature authority to bind and sign on behalf of the grantee.

Authorized Signature for Grantee Printed Name and Title
Printed Name and Title of Signatory Designee\* Date

\* If the Grantee has authorized and designated signature authority to another person, the signatory must print his/her name and title on the appropriate line.

STEP 4 - Return this form, your justification letter and all supporting documentation to your assigned Grant Manager.

DEPARTMENT ACTION:

- Approved as a Modification, subject to any conditions as imposed by the Department
Approved as a Waiver, subject to any conditions as imposed by the Department
Denied (see attached)

Adam Pollet, Acting Director Date

NOTE: Due to the Time Limit on Expenditure of Grant Funds imposed by the Grant Funds Recovery Act (30 ILCS 705/1 et seq.), the extended grant term granted herein shall be deemed to take effect on N/A.

Cc: Tammy Stone; Jennifer Funderburk (Grant Manager); Accounting

\* Waivers will only be approved when the Department determines that it is in the best interest of the State of Illinois.



**Illinois Department of Commerce and Economic Opportunity**

**DCEO GRANT PROGRAM  
REQUEST FOR MODIFICATION/WAIVER\***

**GRANTEE NAME: Macon County**

<b>Part 1 - Budget</b>			
<b>Line Item or Cost Category Description</b>	<b>Approved Grant Budget Amount</b>	<b>Budget Increase/Decrease</b>	<b>Revised Budget</b>
<b>Youth Wages (minimum 70% of total)</b>	400,000	30000	430000
<b>Program Services</b>	5,570	2800	8370
<b>Contractual</b>	75,566	10064	85630
<b>Other</b>	2,000	500	2500
<b>Administrative (maximum 10% of total)</b>	51,864	6636	58500
<b>Total Cost</b>	535,000	50000	585000

<b>Part 2 – Scope of Work</b>			
<b>Project Type</b>	<b>Number of Youth to be Served by Increase</b>	<b>Number of New Youth Served</b>	<b>Number of Returning Youth Served</b>
Work Experience Projects for In-School Youth (16-21)			
Work Experience Projects for Out-of School Youth (16-24)	17	0	17

<b>PAY PERIOD</b>	<b># OF YOUTH TO BE SERVED</b>	<b># FULL-TIME YOUTH (30 HRS+)</b>	<b># PART-TIME YOUTH (&gt;30 Hrs)</b>	<b>PAYROLL COST</b>	<b>TOTAL COST</b>
Dec 9 - 15	19	14	5	6330	9177
Dec 16 -22	19	14	5	6330	9177
Dec 23 - 29	19	14	5	3798	6646
Dec 30 – Jan 5	19	14	5	3798	6646
Jan 6 - 12	19	14	5	6330	9177
Jan 13 - 19	19	14	5	6330	9177
Jan 20 - 26					
			<b>TOTAL</b>	32916	50000



**MACON COUNTY BOARD RESOLUTION  
APPROVING APPLICATION OF THE DECATUR  
PUBLIC BUILDING RENT SURPLUS AND FOR  
REDUCTION IN THE LEVY FOR THE DPBC FUND**

**RESOLUTION NO. G-4031-1-14**

**WHEREAS**, Macon County and the Decatur Public Building Commission (DPBC) have previously entered into a Multi-Facility Lease whereby Macon County leased space in the Law Enforcement Center, the Courthouse, and the Animal Control Facility and agreed to pay rent; and

**WHEREAS**, the DPBC has filed a statement of Surplus Funds related to this lease dated 12-5-13; and

**WHEREAS**, said Multi-Facility Lease in Section 5, Part F, provides for the application of any Rent Surplus to future rent payments.

**NOW, THEREFORE, BE IT RESOLVED** by the Macon County Board that it hereby approves the application of the full amount 2013 Rent Surplus to the Lease Payment to the DPBC thereby reducing the Lease Payment by \$1,247,812.07.

**BE IT FURTHER RESOLVED** that in addition to the tax levies hereinbefore provided by the Macon County Board in and for the County of Macon, Illinois, it is **PROVIDED AND ORDERED** by the said Macon County Board that thereby, and there hereby is, an amendment to the Macon County Board Resolution B-12-11-13 by providing for a **REDUCTION** in the levy upon all taxable property in Macon County, State of Illinois, as equalized for the year 2014, for a **REDUCTION** in the tax of and for the sum of One Million Two Hundred Forty Seven Thousand Eight Hundred Twelve Dollars and Seven Cents (\$1,247,812.07) to meet and defray all of the necessary expenses and liabilities of said Fund.

**BE IT FURTHER RESOLVED** that it is **FURTHER ORDERED AND DIRECTED** that the County Clerk of Macon County, Illinois, be and is hereby directed to extend upon the tax books of Macon County for the year 2014 against all classes of taxable property within the said County, a tax containing a **REDUCTION** in the tax of and for the sum of One Million Two Hundred Forty Seven Thousand Eight Hundred Twelve Dollars and Seven Cents (\$1,247,812.07), such tax to be levied and collected in like manner with the general taxes of said County, and to form when collected a fund to be known as the "DPBC Lease Fund" which said tax shall be in addition to all other taxes which said County is now or hereafter may be authorized to levy on the aggregate of all property within the said county.

**BE IT FURTHER RESOLVED** that this resolution shall become effective immediately upon the adoption thereof.

**PRESENTED, PASSED, APPROVED** this 9th day of January, 2014

AYES \_\_\_\_\_ NAYS \_\_\_\_\_

MACON COUNTY BOARD  
MACON COUNTY, ILLINOIS

ATTEST:

BY:

\_\_\_\_\_  
Stephen M. Bean, Clerk for the  
County of Macon, State of Illinois

\_\_\_\_\_  
Jay A. Dunn, Chairman  
Macon County Board

# DECATUR PUBLIC BUILDING COMMISSION

141 SOUTH MAIN STREET, SUITE 808  
DECATUR, ILLINOIS 62523-1200  
217-424-6044  
FAX 217-424-0850  
December 5, 2013

## Via Hand Delivery

Macon County Auditor  
**Ms. Amy Stockwell**  
Macon County Office Building  
141 S. Main St. Suite 312  
Decatur, Illinois 62523

RE: Surplus Funds – Fiscal Year 2013  
Multiple Facilities Operational Funds  
Macon County Office Building, 141 South Main Street  
Macon County Court's Facility, 253 East Wood Street  
Law Enforcement Center, 333 South Franklin Street  
Macon County Animal Control & Care Facility,  
2820 Parkway Drive

Dear Amy:

Please be advised that for fiscal year 2013, there is a surplus of funds in the amount of One Million, Two Hundred Forty-seven Thousand, and Eight Hundred Twelve and 07/100 Dollars (\$1,247,812.07). These funds have been deposited into the Surplus Account established by the Decatur Public Building Commission and can be applied toward future rent payments as they relate to the **above-referenced facilities**. All funds per the Bond Records are 100% applicable to the County of Macon.

If you need any further information, please contact my office. Thank you.

Sincerely,

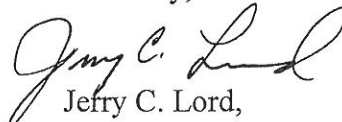
  
Jerry C. Lord,  
Manager

JCL:lt

Cc: DPBC Commissioners  
Edward Booth, Booth Law Office  
Stephen Bean, Macon County Clerk  
Edward D. Yoder, Macon County Treasurer  
Jay A. Dunn, Macon County Board Chairman

12/20/2013

Macon County Payments to Decatur Public Building Commission  
Operations and Maintenance

<u>Pmt Date</u>	<u>Operating Year</u>	<u>Pmt per Lease</u>	<u>Credit Applied</u>	<u>Credit Applied</u>	<u>Payment to DPBC</u>	<u>Surplus Created</u>
12/1/2005	12/1/2005-11/30/2006	\$1,389,610.41	\$168,876.25 (1)	\$212,731.69 (2)	\$1,389,610.41	\$212,731.69
12/1/2006	12/1/2006-11/30/2007	\$3,468,023.25	\$155,005.00 (4)	\$764,272.35 (3)	\$3,086,415.31	\$764,272.35
12/1/2007	12/1/2007-11/30/2008	\$3,652,441.00	\$ 161,578.75 (6)	\$671,425.58 (5)	\$2,733,163.65	\$671,425.58
12/1/2008	12/1/2008-11/30/2009	\$3,869,100.75	\$155,091.25 (8)	\$ 768,166.02 (7)	\$3,036,096.42	\$778,206.06
12/1/2009	12/1/2009-11/30/2010	\$4,085,905.25	\$156,502.50 (10)	\$778,206.06 (9)	\$3,162,647.98	\$628,465.97
12/1/2010	12/1/2010-11/30/2011	\$4,323,244.50	\$170,157.50 (12)	\$628,465.97 (11)	\$3,388,535.94	\$662,435.54
12/1/2011	12/1/2011-11/30/2012	\$4,576,924.50	\$156,326.25 (12)	\$662,435.54 (13)	\$3,778,301.03	\$834,656.63
12/1/2012	12/1/2012-11/30/2013	\$4,838,699.25	\$0.00	\$834,656.63 (14)	\$4,019,937.46	\$1,247,812.07
12/1/2013	12/1/2013-11/30/2014	\$5,120,188.75			\$4,285,532.12	
12/1/2014	12/1/2014-11/30/2015	\$5,422,598.75				
12/1/2015	12/1/2015-11/30/2016	\$5,573,850.00				
12/1/2016	12/1/2016-11/30/2017	\$5,914,384.00				

- (1) City Tenancy Reduction
- (2) FY 2005 Surplus Applied
- (3) Bd Resolution G-3020-2-07
- (4) City Tenancy Reduction 9/07 G-3095-9-07
- (5) BD Resolution (Jan 08)
- (6) City Tenancy Reduction 10/08 G-3246-10-08

- (7) Bd Resolution Feb 2009
- (8) G-3366-11-09
- (9) G-3408-2-10
- (10) City Tenancy Reduction G-3548-1-11
- (11) G-3547-1-11

- "(12) G-3684-3-12
- (13) G-3677-2-12
- (14) G-3823-1-13

	<u>Fy 2007</u>	<u>Fy 2008</u>	<u>Fy 2009</u>	<u>Fy 2010</u>	<u>Fy 2011</u>
Cash Used by DPBC	\$3,086,415.31	\$2,733,163.65	\$3,036,096.42	\$ 3,162,647.98	\$3,388,535.94
Payment in Advance	\$671,425.58	\$ 768,166.02	\$ 778,206.06	\$ 628,465.97	\$662,435.54
Surplus Created	\$2,414,989.73	\$1,964,997.63	\$ 2,257,890.36	\$ 2,534,182.01	\$2,726,100.40
Cash Used					

-18.6% 14.9% *Macon County Auditor Amy C. Spivey*

12/20/2013 2:56 PM

**MACON COUNTY BOARD RESOLUTION  
APPROVING INCREASE IN APPROPRIATIONS  
IN THE GENERAL FUND**

**RESOLUTION NO G-4032-1-14**

**WHEREAS**, a generous donation of \$100,000.00 was received in fiscal year 2013 for the Sheriff to spend on as he saw fit on community outreach activities, and

**WHEREAS**, the Sheriff is using these funds in a matter that will provide outreach to the residents of Macon County, with the goal of making a positive impact on the community and improve the resident's quality of life. Some areas of concentration that funds can be potentially utilized are crime prevention programs, neighborhood organization programs, life skill programs, youth development programs, police programs and supplies that support these efforts; and

**WHEREAS** in FY 2013, the Sheriff distributed \$17,900.00 of this amount, and

**WHEREAS**, the remaining \$82,100.00 from the donation was placed into a Restricted Fund Balance at November 30, 2013 and

**WHEREAS**, an emergency exists whereby valuable community purposes cannot be served without the amending of the FY 2014 budget, and

**WHEREAS**, to enable the Sheriff to make additional awards to community groups as envisioned by the original grant, the FY 2014 budget needs to be amended to increase appropriations as follows:

Additional Expenditure Line A001-060-7600 \$82,100.00

**WHEREAS**, the Finance Committee at its meeting on December 30, 2013 has agreed to the amending of the Sheriff's budget to provide additional appropriations as described above,

**NOW BE IT RESOVED** that the Macon County Board approved increasing appropriations in the Sheriff's budget as described above, and

**BE IT FURTHER RESOLVED** by the Macon County Board that this Resolution shall become effective upon the adoption thereof.

**PRESENTED, PASSED, APPROVED** this 9<sup>th</sup> day of January, 2014.

AYES \_\_\_\_\_ NAYS \_\_\_\_\_

MACON COUNTY BOARD  
MACON COUNTY, ILLINOIS

ATTEST:

BY:

\_\_\_\_\_  
Stephen M. Bean, Clerk for the  
County of Macon County, Illinois

\_\_\_\_\_  
Jay A Dunn, Chairman  
Macon County Board

**MACON COUNTY BOARD RESOLUTION  
APPROVING INCREASE IN APPROPRIATIONS  
IN THE MACON COUNTY HISTORY MUSEUM'S FY13 BUDGET**

**RESOLUTION NO. G- 4033-1-14**

**WHEREAS**, the Macon County History Museum receives funds from Macon County to fund payroll and fringes of History Museum employees; and

**WHEREAS**, due to the retirement of the longtime former Executive Director and the hiring of the new Executive Director, the previously approved payroll funds have exceeded the budget. The overlap of the former director and incoming director was a necessary expense to ensure the smooth transition and adequate training necessary to fulfill the position of Executive Director; and

**WHEREAS**, the overlap of salaries was addressed by Resolution No. G-3996-11-13 approved on November 14, 2013, however the payment of unused vacation days to the former director have made it necessary to again make a request to increase the appropriation; and

**WHEREAS**, the Finance Committee met on December 30<sup>th</sup>, 2013 and were presented with a request to consider the resolution and they recommended for approval to the Macon County Board; and

**NOW, THEREFORE, BE IT RESOLVED** by the County Board of Macon County, Illinois, assembled in regular session this 9<sup>th</sup> day of January, 2014, that it hereby approves the amending of the Macon County History Museum FY13 Budget by increasing the appropriations as follows:

Revenue Line	081-000-4810	\$2,810.00
Expenditure Line	081-000-5001	\$2,810.00

**PRESENTED, PASSED, APPROVED** this 9th day of January, 2014.

AYES \_\_\_\_\_ NAYS \_\_\_\_\_

MACON COUNTY BOARD  
MACON COUNTY, ILLINOIS

ATTEST:

BY:

\_\_\_\_\_  
Stephen M. Bean, Clerk for the  
County of Macon, State of Illinois

\_\_\_\_\_  
Jay A. Dunn, Chairman  
Macon County Board